

MAX VEHICLE ROOF LOAD RATING: 100KG

TOTAL LOAD EQUALS WEIGHT OF ROOF RACKS + ACCESSORIES + CARGO

FIRST TIME INSTALLATION

- Please read instructions carefully before installation.
- Check the contents of kit. Contact your YAKIMA dealer if any parts appear missing or damaged.
- Clean your roof thoroughly prior to fitting the LOCKN'LOAD Track Heavy Duty Roof Rack System.
- Place these instructions in the vehicle's glove box after installation is complete.



TOOLS REQUIRED:

- 10mm Open Ended Spanner
- 13mm Socket or Spanner
- Ø4-5mm Centre Punch
- Ø4-5mm Pin Punch tool
- Power or Cordless Drill
- Vacuum Cleaner
- Mastic Silicone Sealant
- Rubber Mallet (Optional)
- #2 Phillips Head Screwdriver
- Zinc Rich Cold Galvanising Coating
- Marking Pen
- Tape Measure
- Masking Tape
- Rivet Gun
- Scissors
- 4mm Drill Stop
- Cardboard Strips

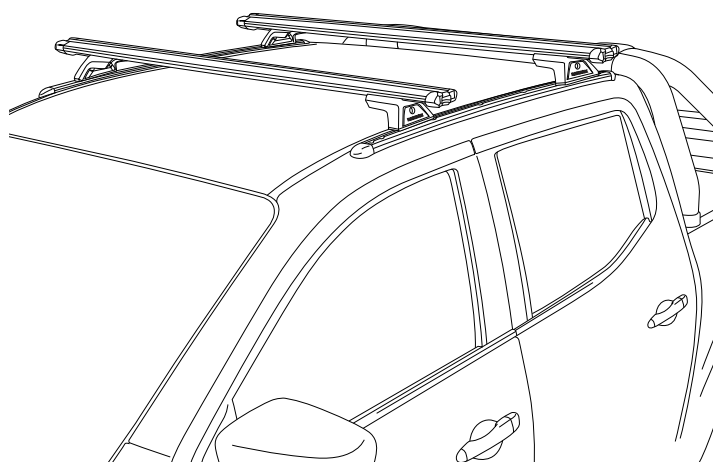

KIT CONTENTS

ITEM	COMPONENT	QTY	ITEM	COMPONENT	QTY
1.	Track Nissan Navara Left Hand Side	x1	7.	Ø4.9mm Drill Bit	x1
2.	Track Nissan Navara Right Hand Side	x1	8.	M6 Hex Screw	x8
3.	Track Nut Plate	x4	9.	End Cap Front Left & Rear Right	x2
4.	M6 Washer	x8	10.	End Cap Front Right & Rear Left	x2
5.	M6 Spring Washer	x8	11.	Rivet Gun Nozzle	x1
6.	Ø4.8mm Rivet	x16			



LEG AND BAR COMPONENTS SOLD SEPARATELY

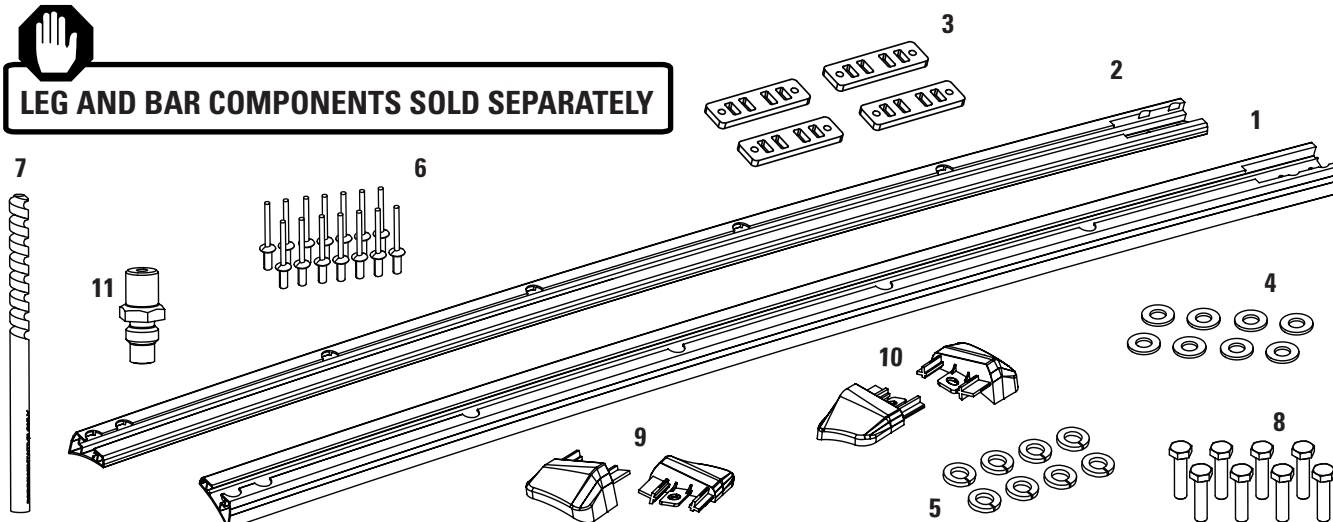

TRACK INSTALLATION

1

BEFORE BEGINNING INSTALLATION

Clean roof thoroughly and allow to dry before beginning installation.

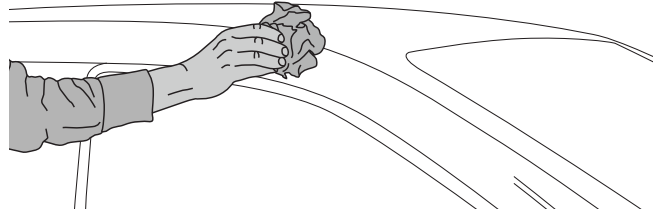

2

TRACK ORIENTATION

Identify Left Hand Side (LHS) and Right Hand Side (RHS) Tracks as shown below.

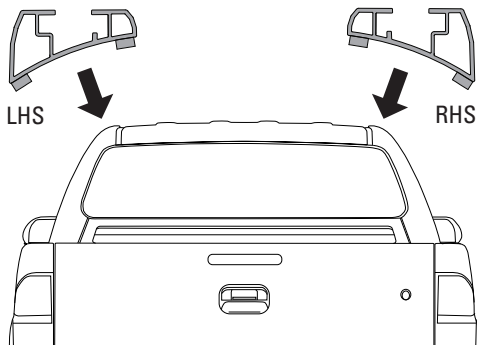

FRONT

REAR

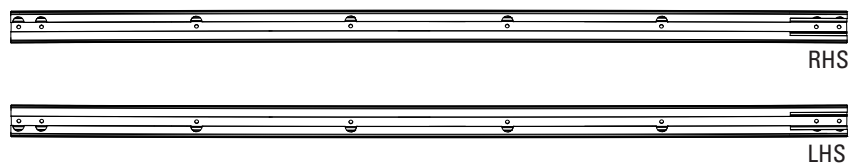

NOTE - The front of the tracks are to be positioned with the front of the vehicle.

3

APPLY MASKING TAPE

Apply lengths of Masking Tape along window and door seals.

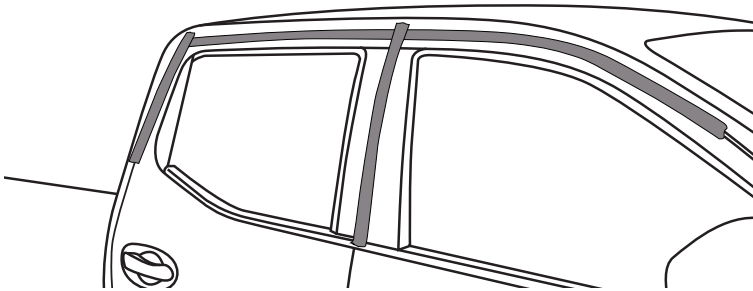

NOTE - This prevents drill swarf from getting caught.

4

FRONT TRACK MEASUREMENT

Apply Masking Tape along ditch. Measure 246mm from front corner of ditch and record.

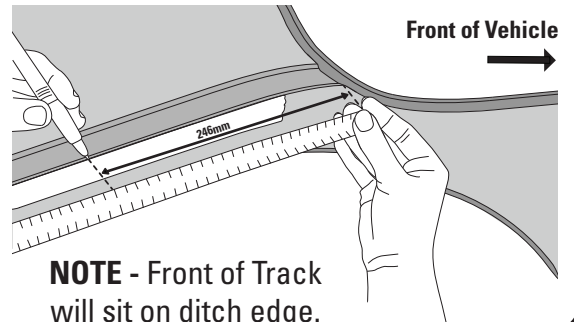

NOTE - Front of Track will sit on ditch edge.

5

REAR TRACK MEASUREMENT

Place Track on outer section of roof. Ensure front of Track aligns with reference mark. Once placed, record rear of Track position. Remove Track.

Measure 8mm from outer edge of ditch. Mark line which intersects with rear of Track reference line.

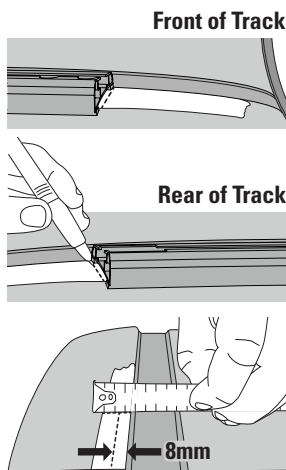

6

POSITION TRACK AS SHOWN

Front of Track

Rear of Track

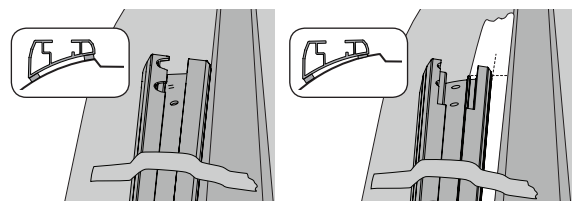

Once positioned, secure well in place with Masking Tape.

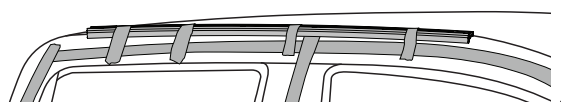

7

MARK DRILL HOLES

Re-check measurements and position of Track with Tape Measure. Once confirmed, mark locations of all track holes on roof with Marking Pen. Remove track.

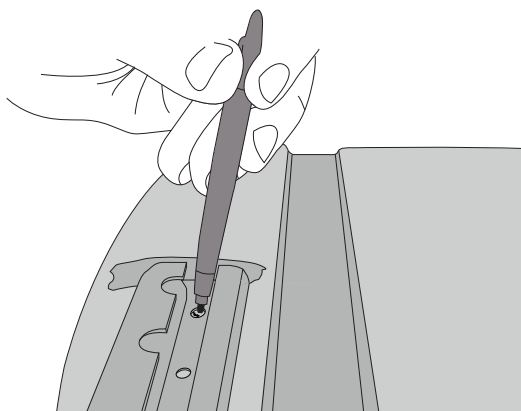

8

CENTRE PUNCH HOLES

Lightly centre punch all marked holes.

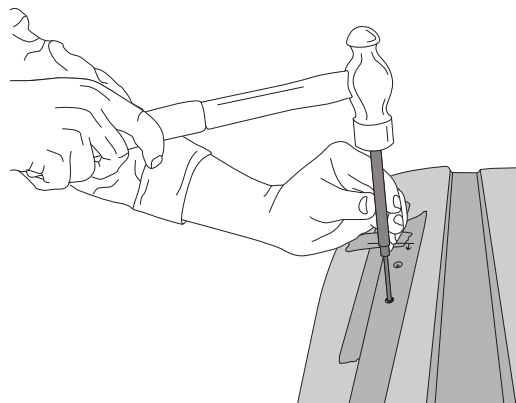

Place track onto vehicle to check all centre punch marks line up with Track holes. If necessary, re-measure to confirm.

9

DRILL ROOF

Using the Ø4.9mm Drill Bit provided and an 4mm Drill Stop, carefully drill through the roof at each centre punched location. Ensure a drilling angle perpendicular to the roof surface is maintained throughout.

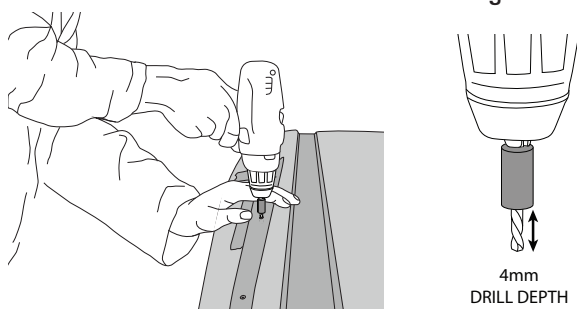

NOTE - A Drill Stop is used to avoid drilling into the second roof skin of the vehicle.

10

REMOVE SWARF

Using a Vacuum Cleaner carefully remove swarf from roof, taking care not to scratch the vehicle. Remove Masking Tape and gently wipe clean with a damp cloth.

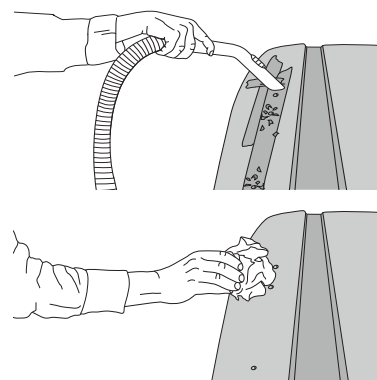

Allow to dry completely before proceeding.

11

RIVET CLEARANCE

The second roof skin requires the four middle holes to be modified with a Pin Punch tool to accommodate the Rivets. Using a Ø4-5mm Pin Punch tool, carefully dent the metal skin of **the four middle holes only** as shown to allow clearance for Rivets. The two holes at each end have sufficient clearance.

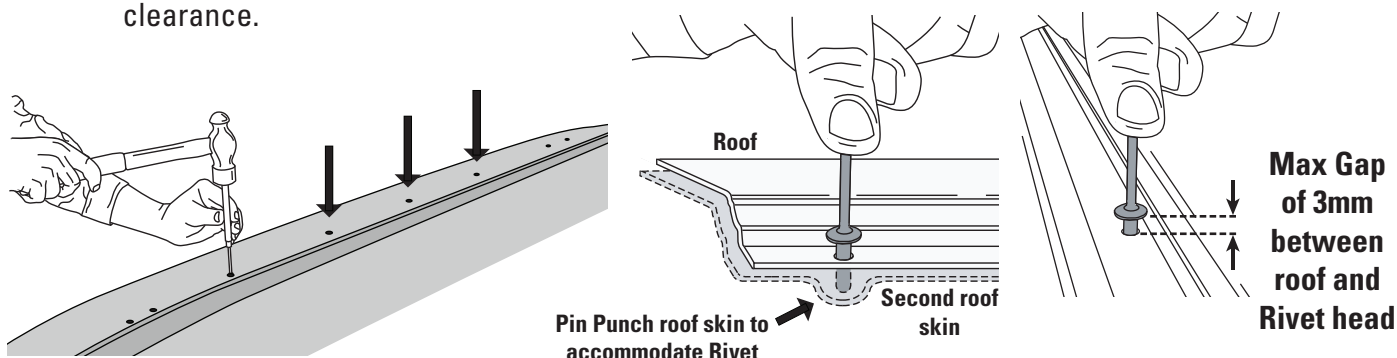

12 APPLY PROTECTIVE SEALANTS

Protect roof by applying liberal amounts of protective sealants, as described.

Stage 1

Apply a Zinc Rich Cold Galvanising Compound to inside surface and surrounds of each drilled hole. Allow solution to become touch dry before proceeding with Stage 2, (approx. 10 minutes depending on product).

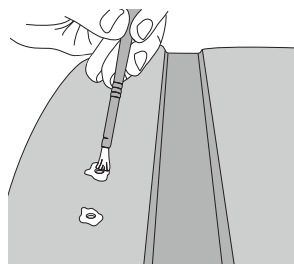

Stage 1
Apply Zinc Rich Cold Galvanising Compound liberally in and around holes

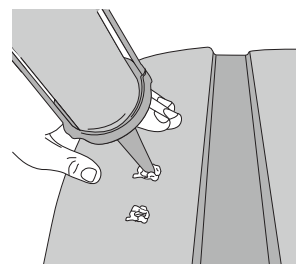

Stage 2
Apply Mastic Silicon liberally in and around holes

Stage 2

Apply a Mastic Silicone Sealant to the inside surface and surrounds of each hole.

13 FIT END CAPS TO TRACKS

Refer to letter on underside of End Cap to identify type. Insert End Caps into Track ends as illustrated.

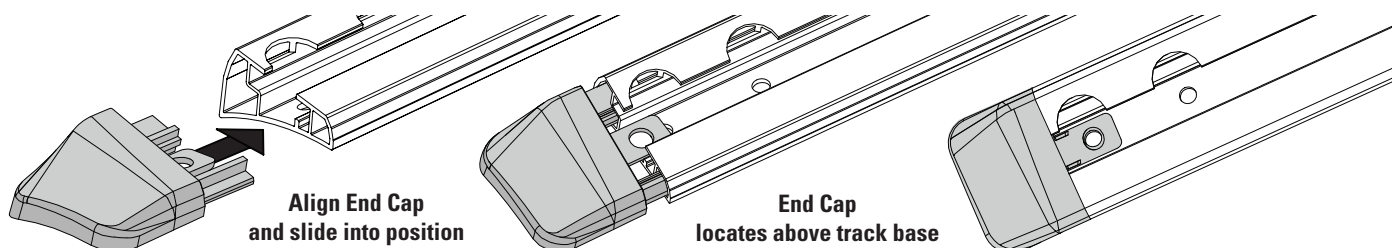
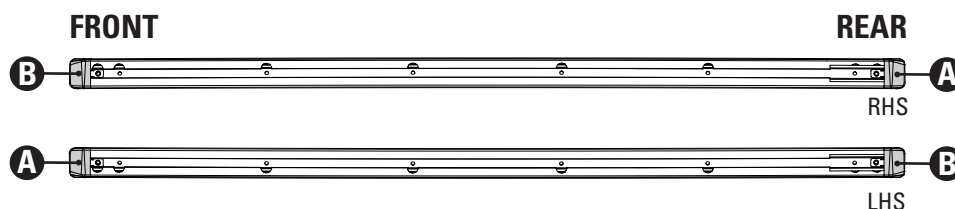

14 POSITION TRACK BACK ONTO VEHICLE

Taking note of correct orientation, place Track onto vehicle. Insert Rivets through Track holes and End Caps to align. Once located, secure well with Masking Tape.

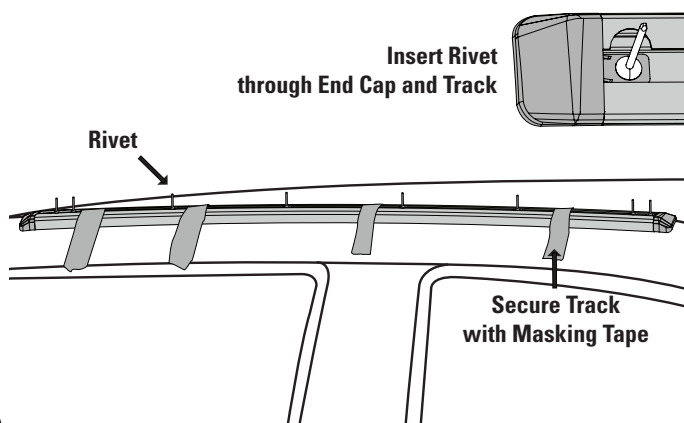

15 PRIOR TO RIVETING

Place Cardboard Strips either side of Track **prior to riveting** to prevent accidental scratching of the roof body should the Rivet Gun slip.

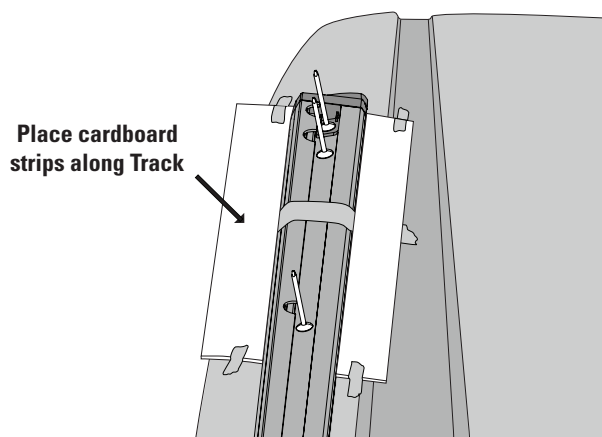

16 RIVETING TRACK TO VEHICLE

Ensure good pressure is applied to the Track. We recommend an assistant helps. Using the Rivet Nozzle provided, rivet the centre of the Track, then continue in an alternating pattern out towards the end of the Track.

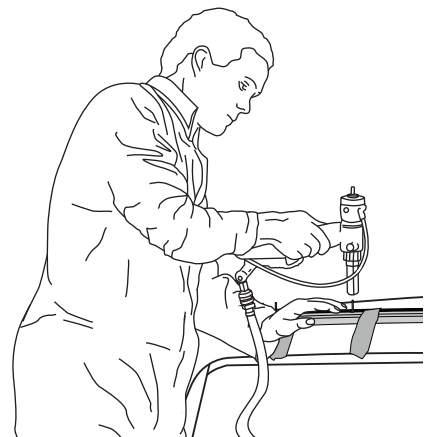
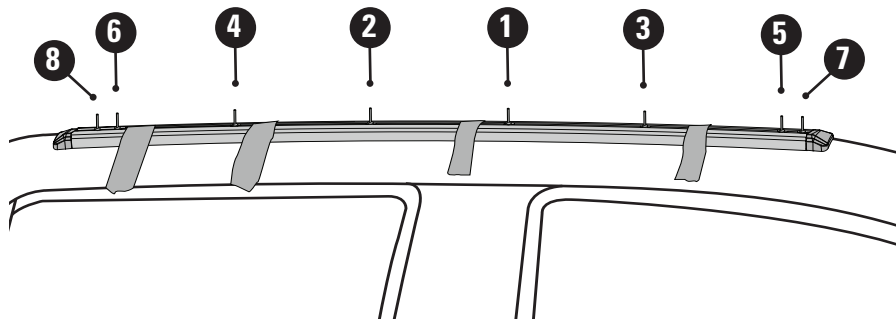

17 TRACK INSTALLATION COMPLETE

Check both Tracks are secured to the vehicle as per these installation instructions. For assistance please contact your local Yakima Dealer.

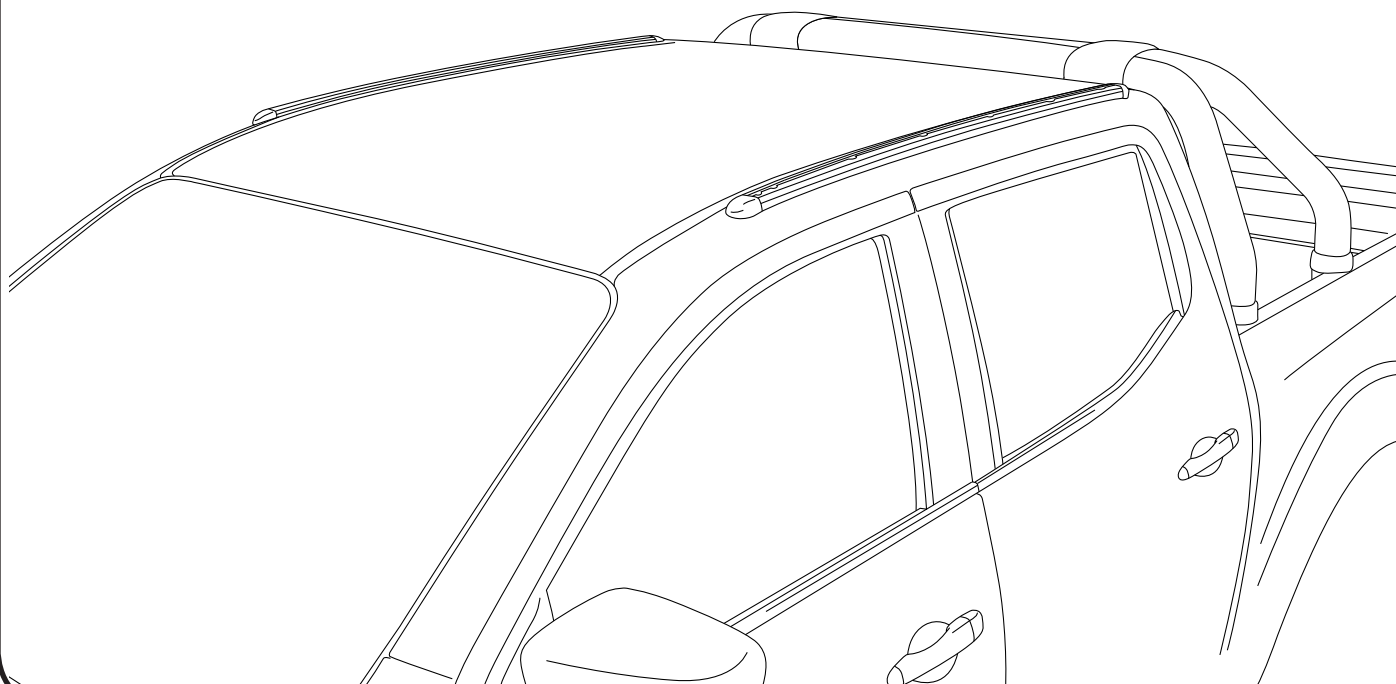

PLEASE SEE STEPS 18-41 FOR BAR INSTALLATION

BAR INSTALLATION

18 REMOVE LEG COVERS

Using the keys supplied in the LOCKN'LOAD Leg Kit (sold separately), remove all Leg Covers.

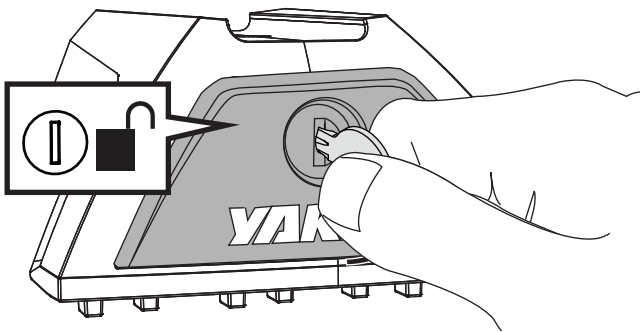

19 LEG ASSEMBLY

From the LOCKN'LOAD Leg Kit, position Nut Plates over holes on top of Legs.

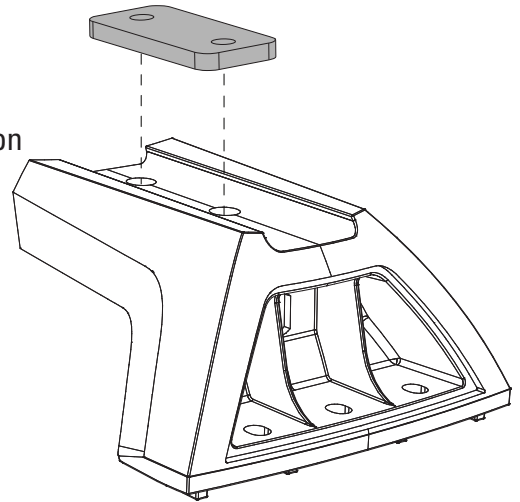

20 ASSEMBLE SCREWS AND WASHERS

From the LOCKN'LOAD Leg Kit, assemble 1 x M8 Spring Washer and 1 x M8 Washer onto each M8 Set Screw 16mm in the order shown.

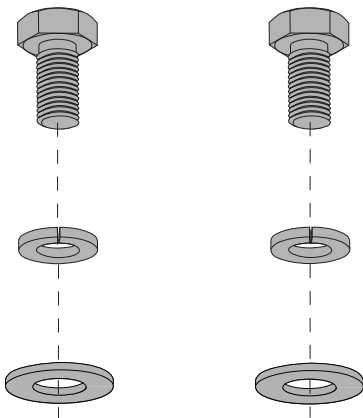

21 ASSEMBLE NUT PLATES AND LEGS

Loosely hand tighten Nut Plates to Legs, as shown, using the screw assemblies from the previous Step. **Ensure there is a sufficient gap between the Nut Plates and Legs for the next Step.**

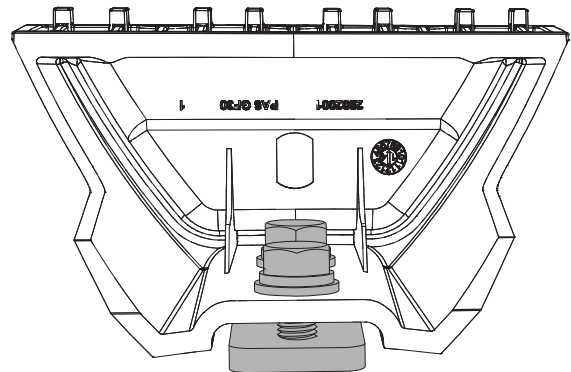

22 INSERT LEGS

Slide Leg assemblies into the underside channel of LOCKN'LOAD Bars (sold separately).

If Leg assemblies will not slide in, loosen Screws to increase gap.

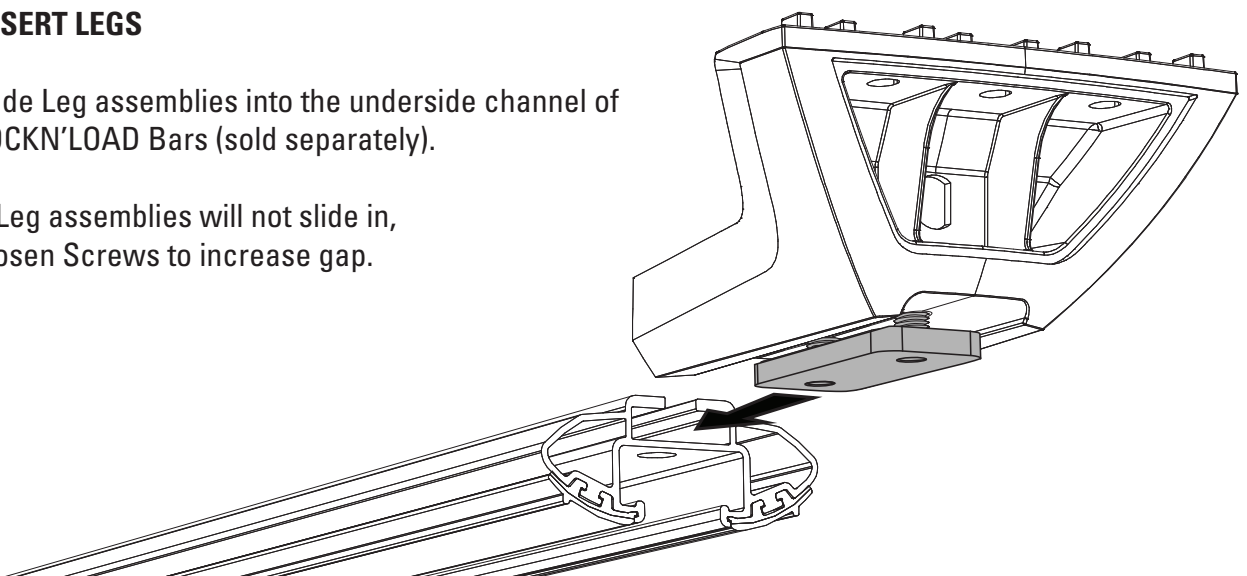

23

BAR LOCATION

IMPORTANT: Before beginning Bar installation, identify where along the Track you want the Front and Rear Bars fitted. We recommend a minimum of 700mm between Bars.

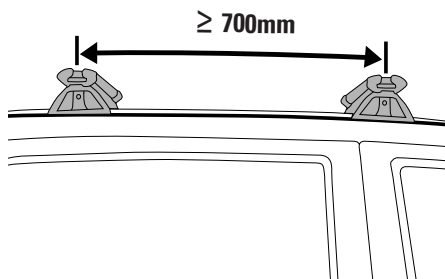

24

BAR PLACEMENT

Carefully place a Bar assembly over Track. **Take care not to damage vehicle.** Slide Legs along Bar until both legs are securely positioned within Track. Use a Tape Measure to ensure even Bar overhang on each side, re-adjust if required. Finger tighten one Screw on each Leg to secure Leg position along Bar. Repeat for remaining bar assembly then carefully remove Bars from vehicle.

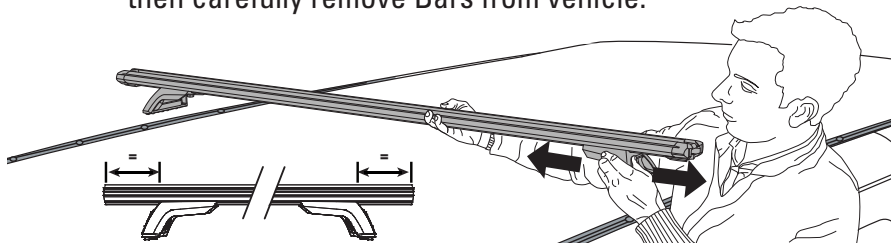

NOTE - Front and Rear Bars require individual adjustment due to tapered roof. Bars must be installed perpendicular to Tracks.

25

CHECK BAR SLOT MEASUREMENTS

Place Bars on flat surface with legs facing upwards, as shown. Take appropriate measures to avoid scratching the product and surface. Identify slot on each Bar end. Using a Tape Measure, record the inner slot length of each Bar in the Table, (right).

BAR SLOT MEASUREMENTS	
Front Bar (X)	Rear Bar (Y)
_____mm	_____mm

MEASURE FRONT AND REAR BARS

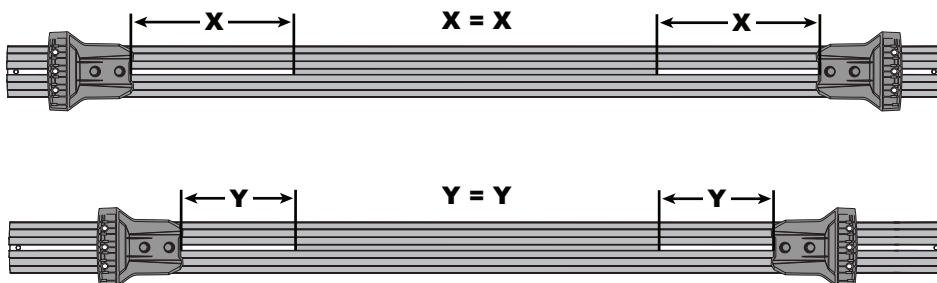

Remove Legs from Bar once equal measurement is obtained and recorded. Loosen the previously hand tightened screw on each leg, keeping Nut Plate and Screw assemblies in place as shown.

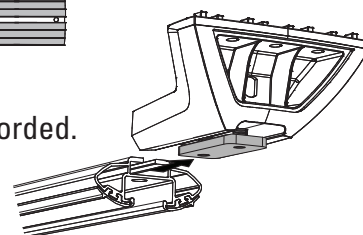

26

BAR SLOT COVERS

Cut Bar Slot Covers as per measurements recorded in the table above and insert into underside channel of front and rear Bar ends as shown.

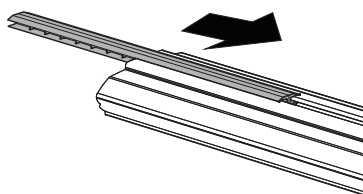
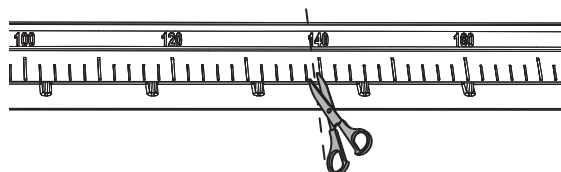

NOTE - Bar Slot Covers to be inserted with flat side visible

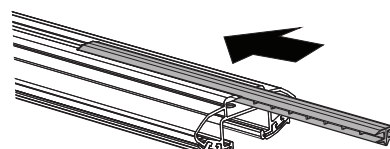

27**INSERT LEGS**

Slide Leg assemblies into the underside channel of LOCKN'LOAD Bars. Slide in until Leg reaches Slot Cover.

Do not compress slot cover.

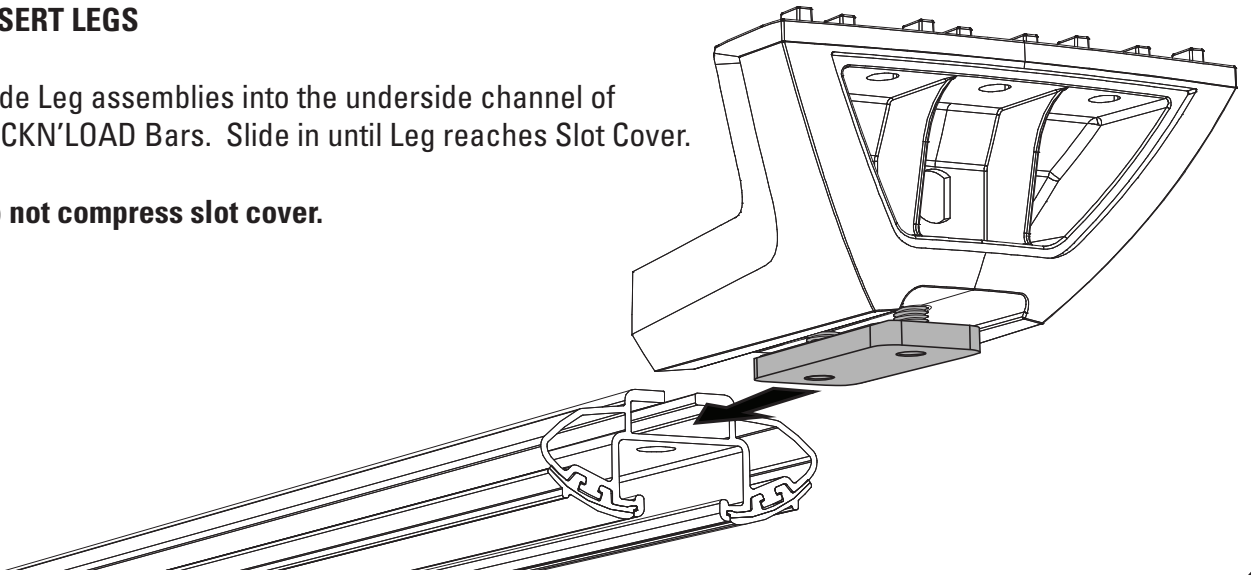
**28****SECURE LEGS TO BARS**

Tighten all M8 Set Screws to 7Nm using a 13mm Socket Wrench.

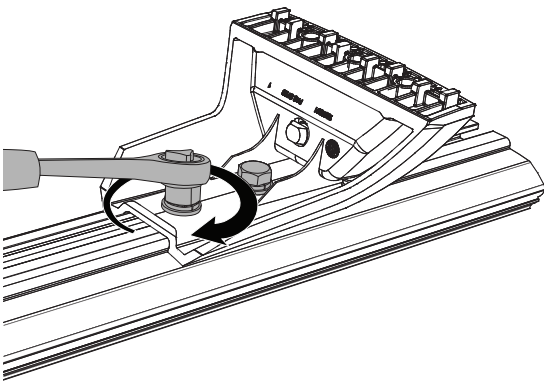
**29****BAR SLOT COVERS (OUTSIDE LEG)**

Measure the Bar channel outside of the Legs and subtract 20mm from this measurement. Using the remaining pieces of Slot Cover from Step 26, cut to this length and insert into the underside channel of each Bar end as shown.

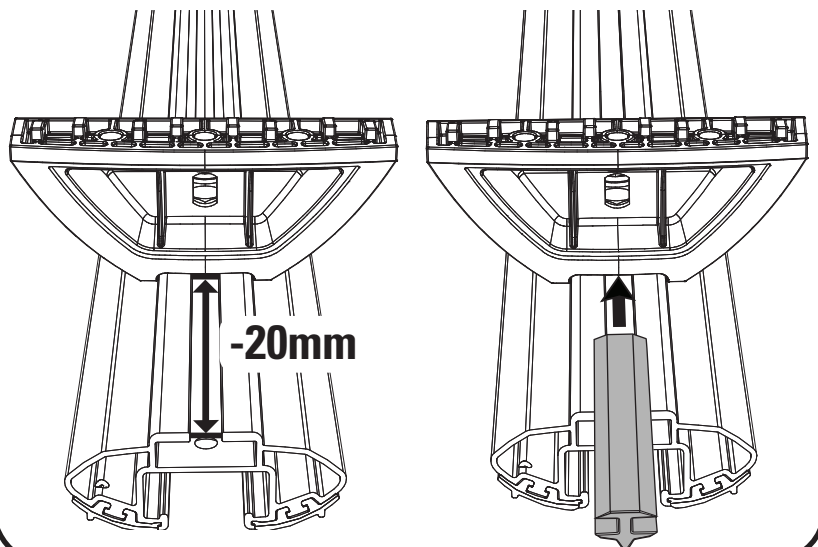
**30****END CAP ASSEMBLY #1**

From the LOCKN'LOAD Leg Kit, insert Bottle Openers and Pins into the End Cap Halves.

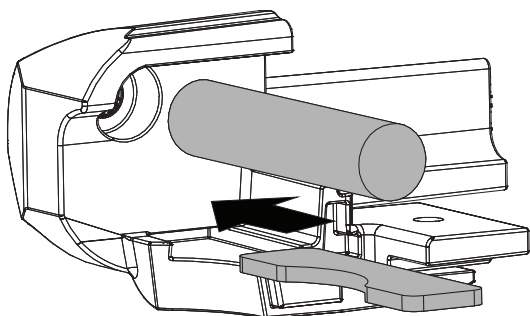
**31****END CAP ASSEMBLY #2**

Connect all End Cap Halves together.

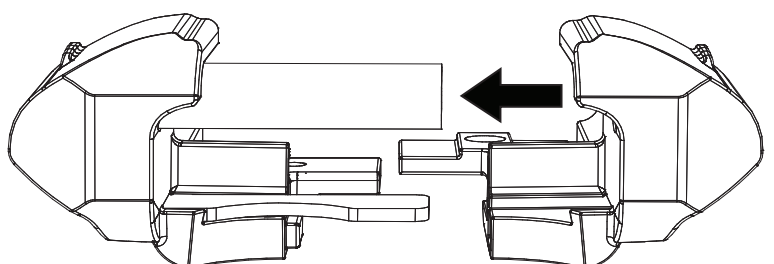

32**INSERT END CAPS TO BARS**

Insert the End Caps as shown. A Rubber Mallet can be used to assist installation.

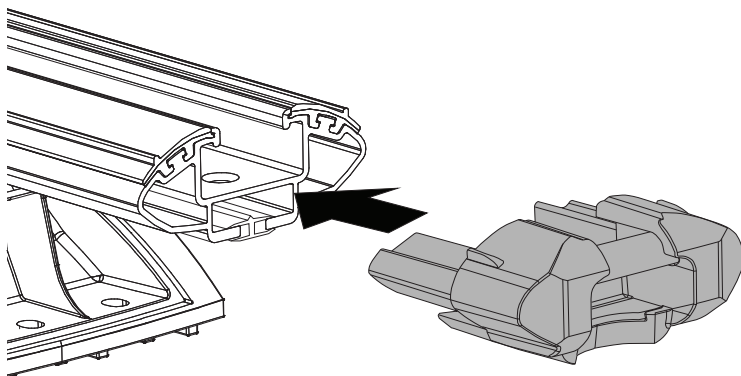
**33****SECURE END CAPS TO BARS**

Secure using Plastite Screw (from LOCKN'LOAD Leg Kit). Tighten using a #2 Phillips Head Screwdriver.

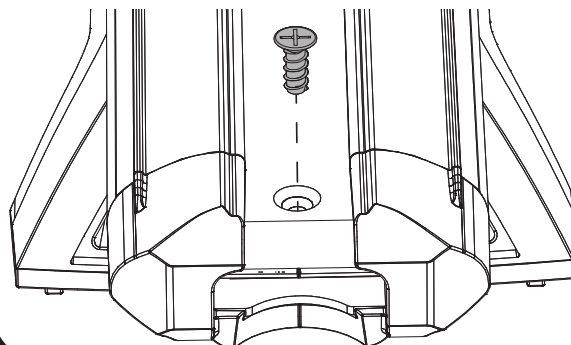
**34****INSERT NUT PLATES**

Run all M6 Hex Screws through Nut Plates to remove burs.

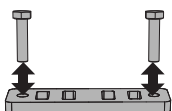

Insert two (2) Nut Plates into each Track as shown.

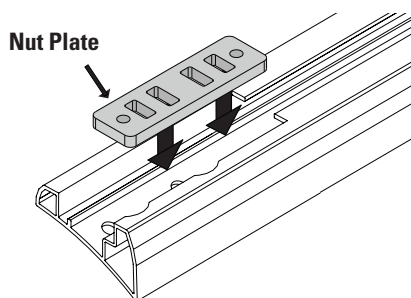
**35****BAR FITMENT**

Slide Nut Plates within Track into position for front and rear Bar placement. Place Bar assembly onto Tracks, carefully locating the four central raised notches on base of Legs into the cut outs on Nut Plates as shown. **Take care not to damage vehicle.** Repeat for remaining Bar.

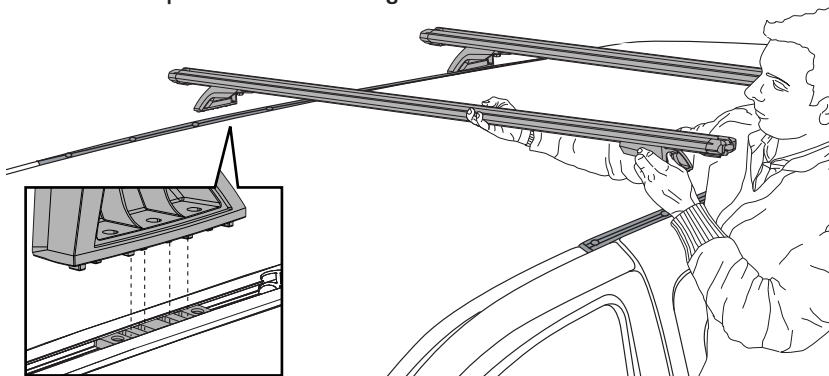
**36****HAND TIGHTEN SCREWS**

From the LOCKN'LOAD Track Kit, assemble 1 x M6 Spring Washer and 1 x M6 Washer onto each M6 Hex Screw as shown. Insert through the outer holes on Legs into Nut Plate as shown. Finger tighten Screws.

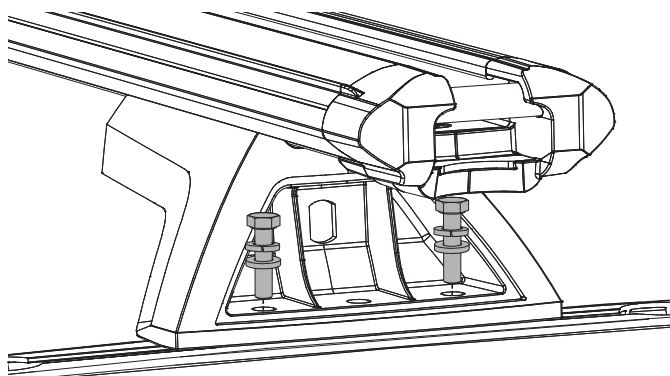
**37****BAR POSTION**

Position front and rear Bars along Tracks as required, ensuring there is a minimum distance of 700mm between each Bar. Measure from the centre of each Leg as shown.

≥ 700mm

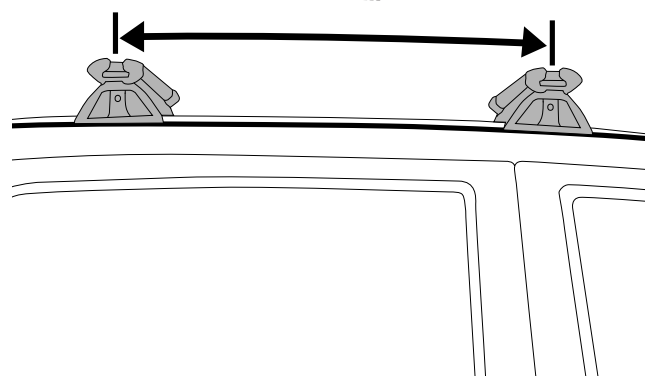

38**TIGHTEN SCREWS**

Tighten all M6 Hex Screws to 5Nm using a 10mm Open Ended Spanner. **Do not over tighten.**

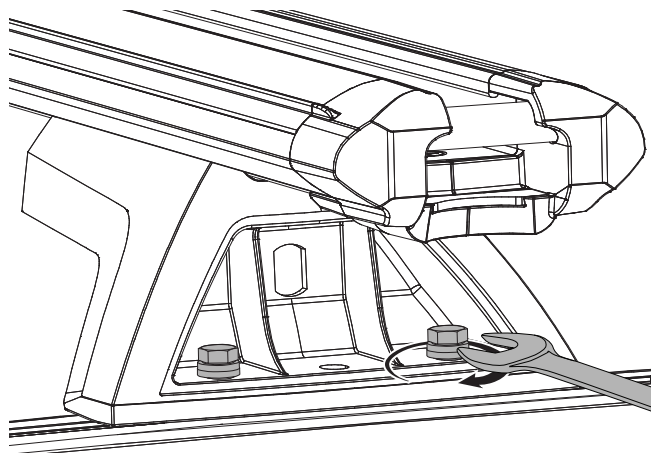
**39****CHECK BAR LEGS ARE SECURE**

Check all Bar Legs are secure.

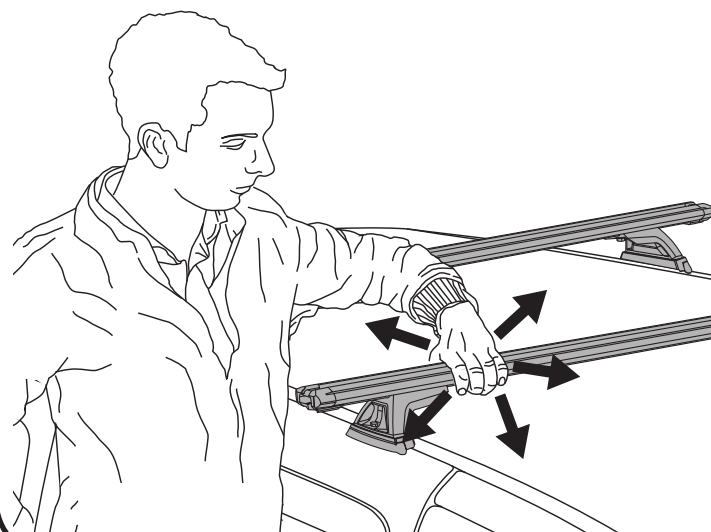
**40****FIT LEG COVERS**

Using the keys and Covers supplied in the LOCKN'LOAD Leg Kit, fit and lock all Leg Covers.

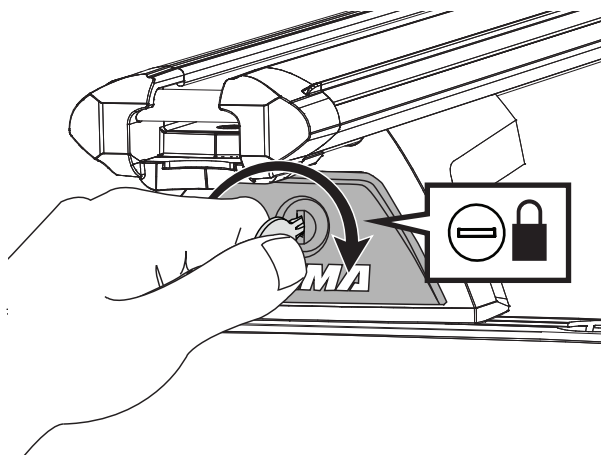
**41****BAR KEYS**

Place one key on the vehicle key ring and put the other away safely, or store with the spare vehicle key.

Write the key number (which is stamped on the key) in the box provided. Replacement keys are available from Yakima stockists, visit www.yakima.com.au or www.yakima.co.nz to find your nearest store or contact us directly on 1800 143 548 (AU) or 0800 4776 722 (NZ).

Key Number: