

MAX VEHICLE ROOF LOAD RATING: 100KG

TOTAL LOAD EQUALS WEIGHT OF ROOF RACKS + ACCESSORIES + CARGO

FIRST TIME INSTALLATION

- Please read instructions carefully before installation.
- Check the contents of kit. Contact your YAKIMA dealer if any parts appear missing or damaged.
- Clean your roof thoroughly prior to fitting the LOCKN'LOAD Track Heavy Duty Roof Rack System.
- Place these instructions in the vehicle's glove box after installation is complete.



TOOLS REQUIRED:

- Marking Pen
- Tape Measure
- Masking Tape
- Power or Cordless Drill
- 3mm Drill Bit
- 7mm Drill Bit
- Drill Bit Stop
- Mastic Silicone Sealant
- Flat Blade Screwdriver
- #2 Phillips Head Screwdriver
- Zinc Rich Cold Galvanising Coating
- Vacuum Cleaner
- 10mm Open Ended Spanner
- 13mm Socket or Spanner
- Rivet Gun
- Scissors
- Tin Snips
- Metal File
- Die Grinder (D-Max SX only)
- Rubber Mallet (Optional)

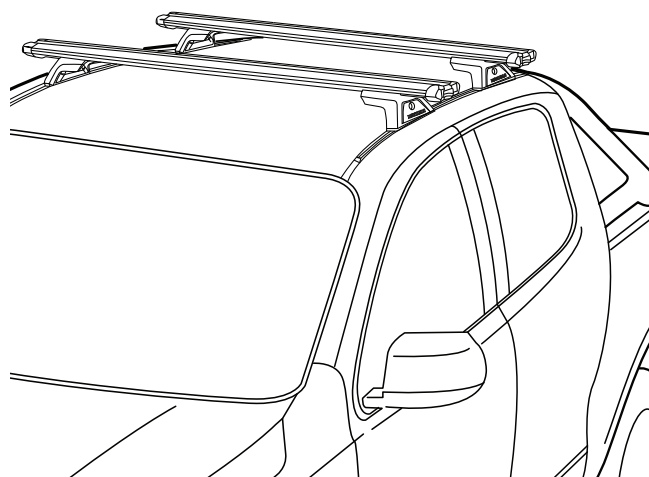

KIT CONTENTS

ITEM	COMPONENT	QTY	ITEM	COMPONENT	QTY
1.	Track Colorado/D-Max Right Hand Side	x1	8.	M6 Hex Screw	x8
2.	Track Colorado/D-Max Left Hand Side	x1	9.	Track End Cap	x4
3.	Track Nut Plate	x4	10.	M8 Button Head Screw	x8
4.	M6 Washer	x8	11.	M8 Spring Washer	x8
5.	M6 Spring Washer	x8	12.	M8 Washer	x8
6.	Rivet	x8	13.	5mm Allen Key	x1
7.	4.9mm Drill Bit	x1			



LEG AND BAR COMPONENTS SOLD SEPARATELY

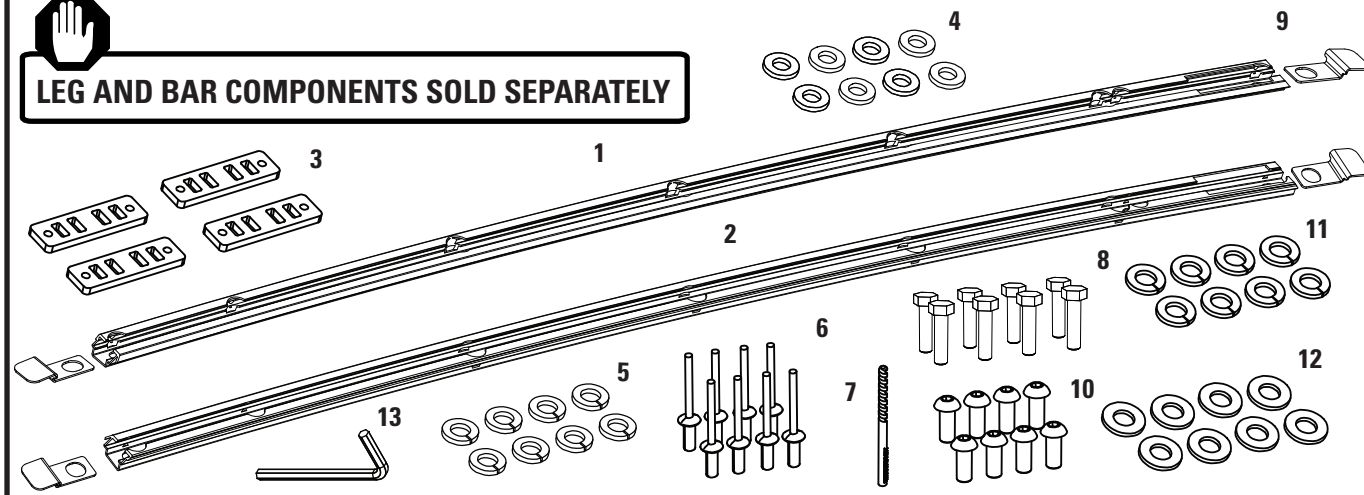

TRACK INSTALLATION

1

BEFORE BEGINNING INSTALLATION

Clean roof thoroughly and allow to dry before beginning installation.

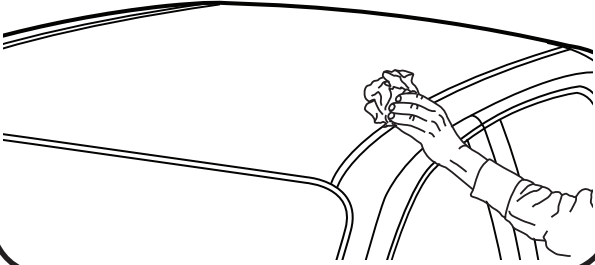

2

TRACK ORIENTATION

The foam tape on side of Tracks faces **outside of vehicle** as shown, with rectangular cut outs at rear of vehicle.

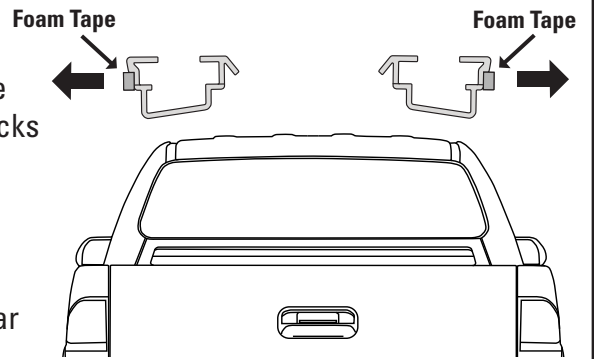

NOTE - image as viewed from rear of vehicle

3

TRACK SET-UP

It is recommended to completely install one track at a time.

Holden Colorado / Isuzu D-Max LS, LS-U, LS-M

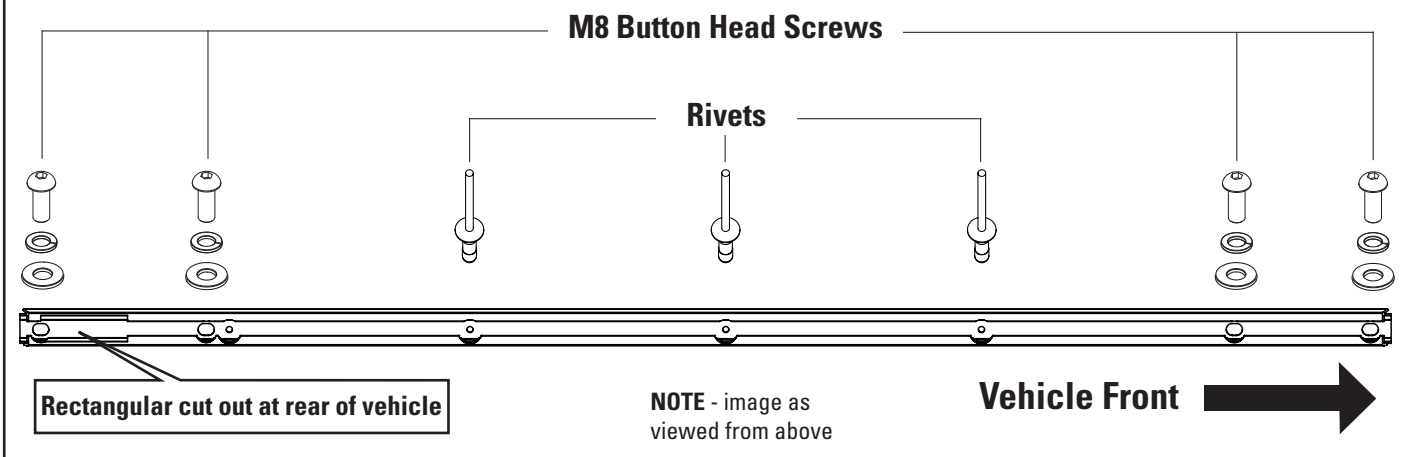

Isuzu D-Max SX

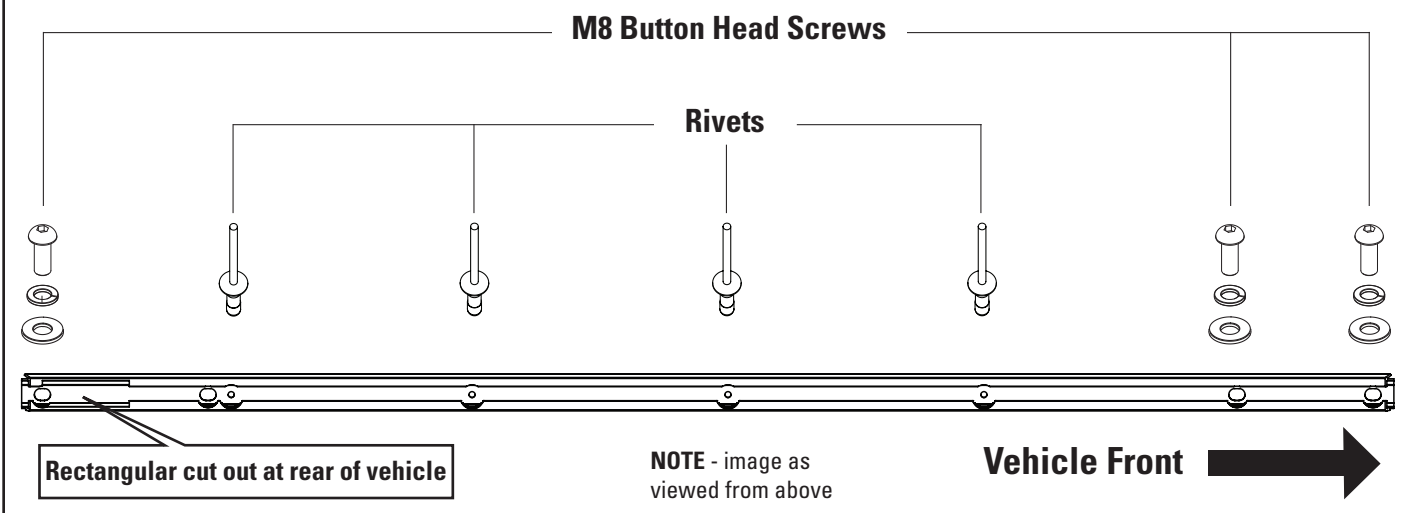

4**MEASURE ROOF TRIM**

Using a Tape Measure, measure 1420mm from the edge of the windscreen rubber (not glass edge) back along rubber roof channel trim. Ensure to measure from the centre of roof trim as shown. Use a pencil to mark measurement at 1420mm and another at 230mm.

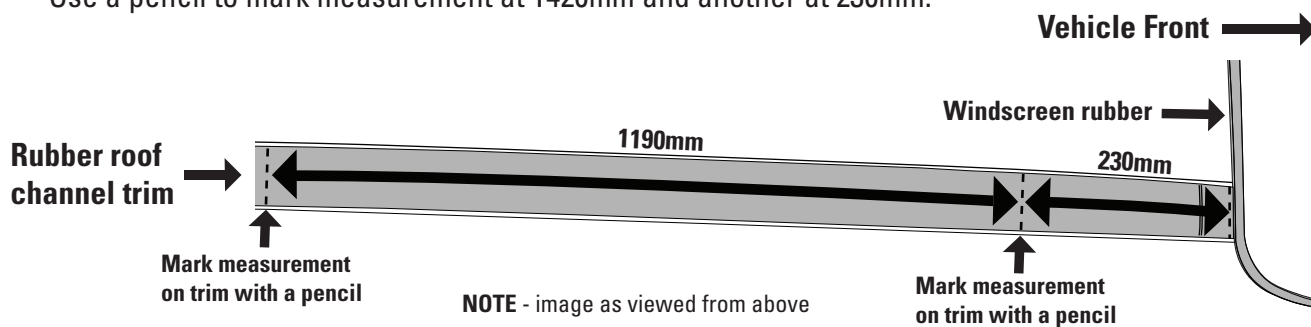
**5****DRILL ROOF TRIM**

The measurements can now be carefully drilled through using a 3mm Drill Bit (not supplied) by drilling three holes through the trim at the two marked locations. The trim has a stainless steel section inside. **Do not drill into the roof.**

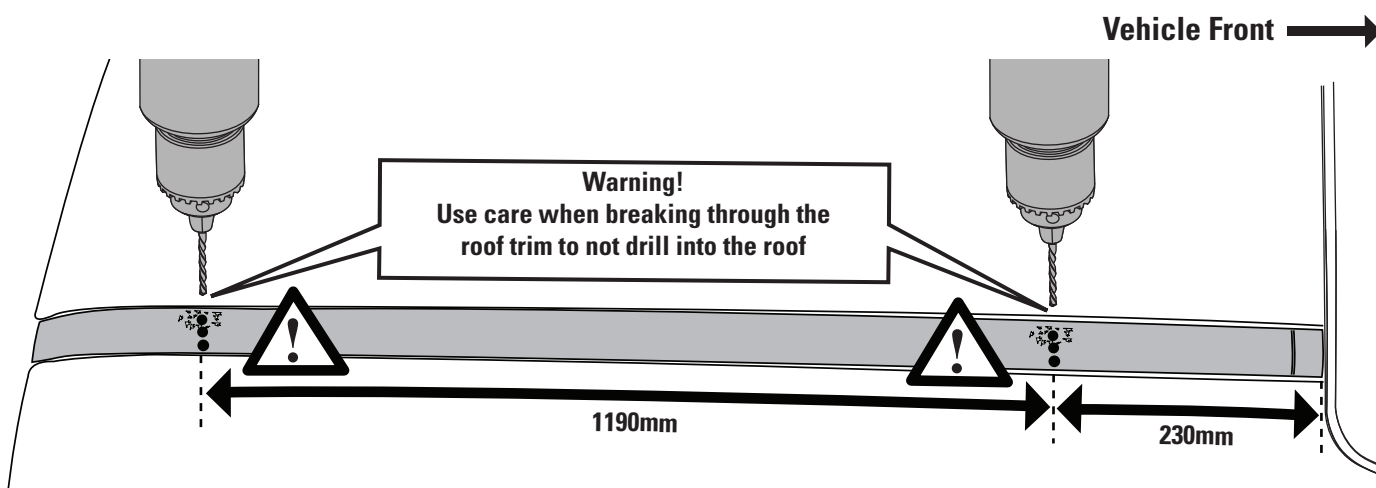
**6****CUT ROOF TRIM**

To protect paint work, place Masking Tape over middle of roof as shown. Gently lever up the middle of rubber roof channel trim with a Flat Blade Screwdriver (wrap tape around end of Screwdriver to prevent paint scratching). Use Tin Snips to cut through middle of trim.

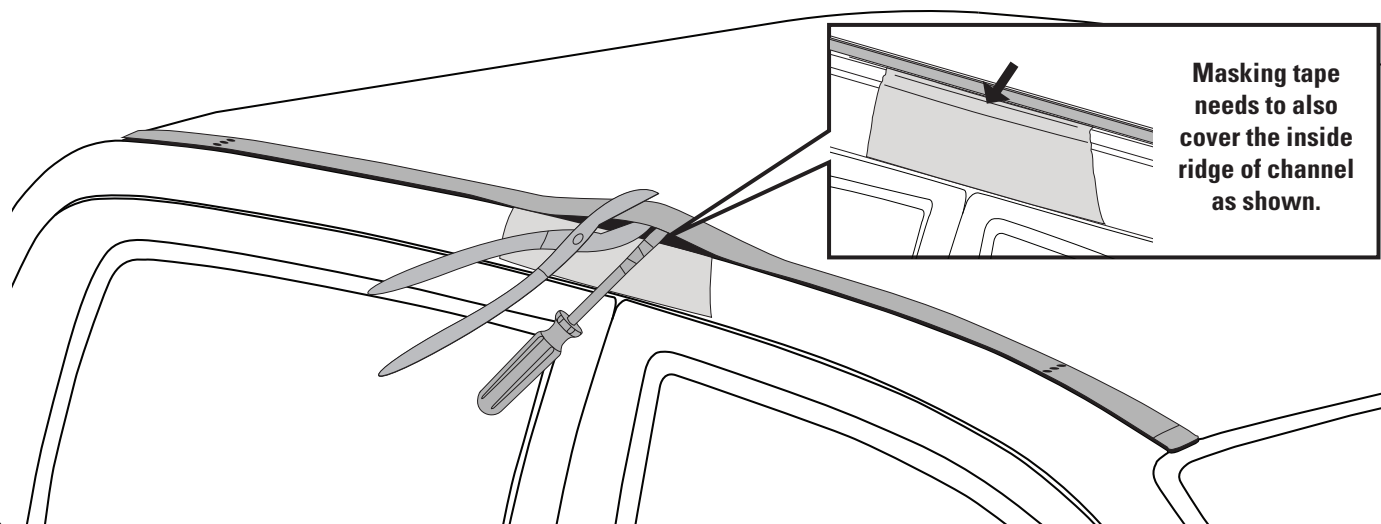

7

BREAK ROOF TRIM

Using your thumb to support trim at drilled holes, bend the cut trim sections back and forth to break at drilled holes. Some force may be required to snap the stainless steel section in trim.

Neaten edges where trim has broken as much as possible. Remove all Tape from vehicle roof.

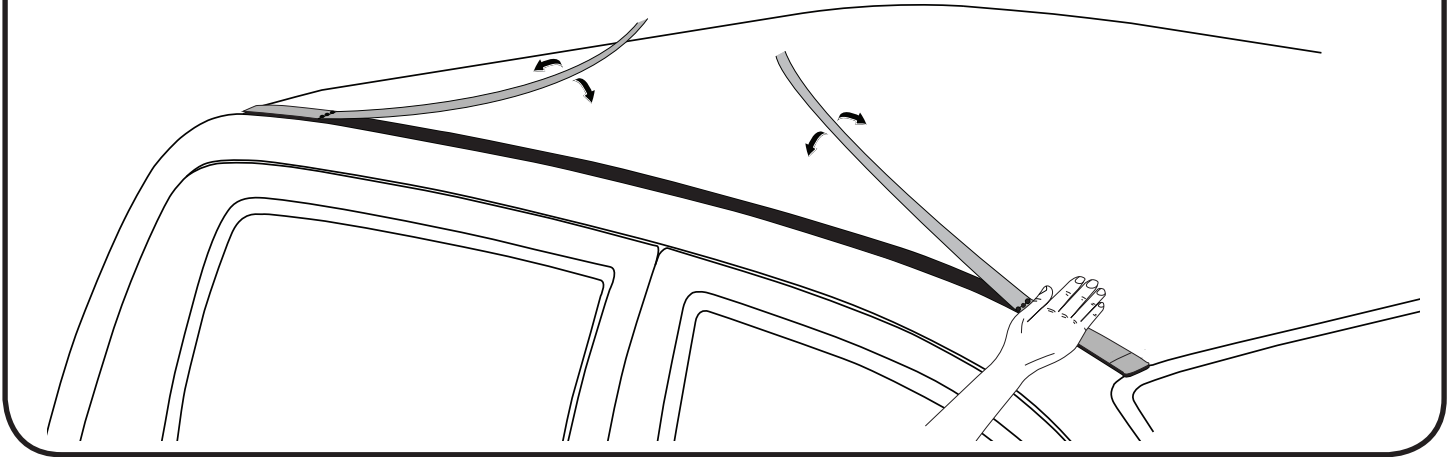

8

REVEAL MOUNTING POINTS

With the trim pieces removed, the M8 mounting points can now be accessed. The mounting points are covered with paint and tape. Use a sharp tool to remove paint and peel away tape covering holes to reveal screw thread. If the roof panel overlaps the hole and impedes on accessing the thread, carefully file the roof panel to allow clearance for inserting the M8 Button Head Screws.

NOTE - Isuzu D-Max SX Models do not feature a third (#3) mounting point. Proceed to Page 9 for supplement D-Max SX fitting instructions.

File overlapping panel if shape of hole won't allow clearance for inserting the M8 Button Head Screws.

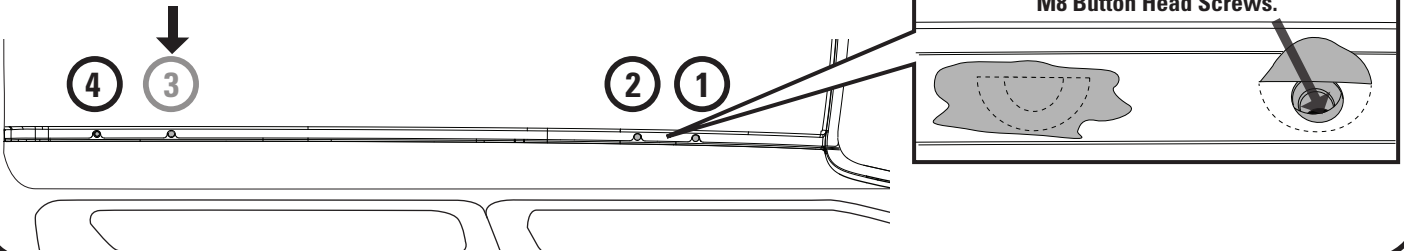

9

ALIGN AND SECURE TRACK

Place Track into roof channel, ensuring Track orientation is correct as shown.

Align Track and eliminate movement within the roof channel during spot drilling by inserting M8 Button Head Screws into each of the mounting holes through track. Secure using the supplied Allen Key. Isuzu D-Max SX models secured using holes 1, 2 and 4.

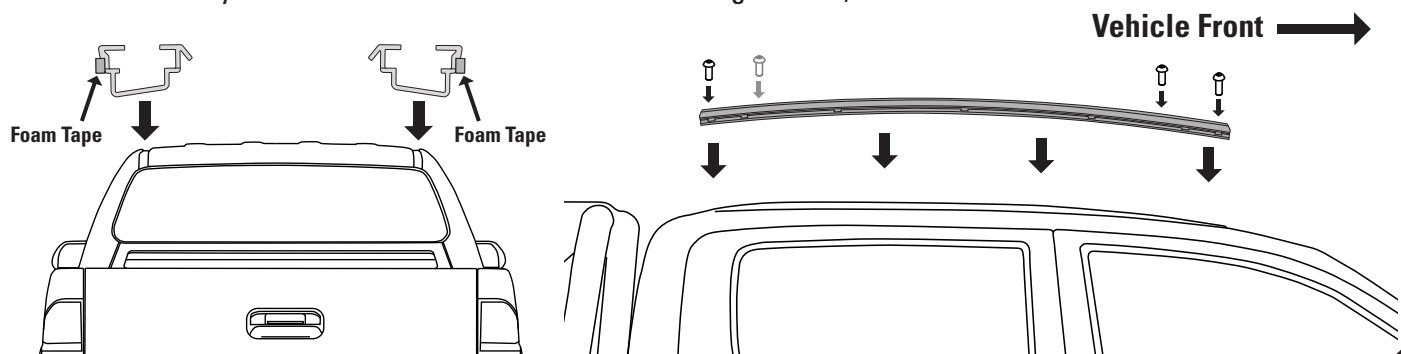

10**SPOT DRILL RIVET HOLES**

Using the supplied 4.9mm Drill Bit, drill each of the applicable rivet holes as shown below. **Start from the rear of the vehicle working consecutively frontward.** Ensure the Track does not move during this process by maintaining downward pressure on the Track while spot drilling holes. Use the help of an assistant if required. Once complete, remove Track taking care not to scratch vehicle.

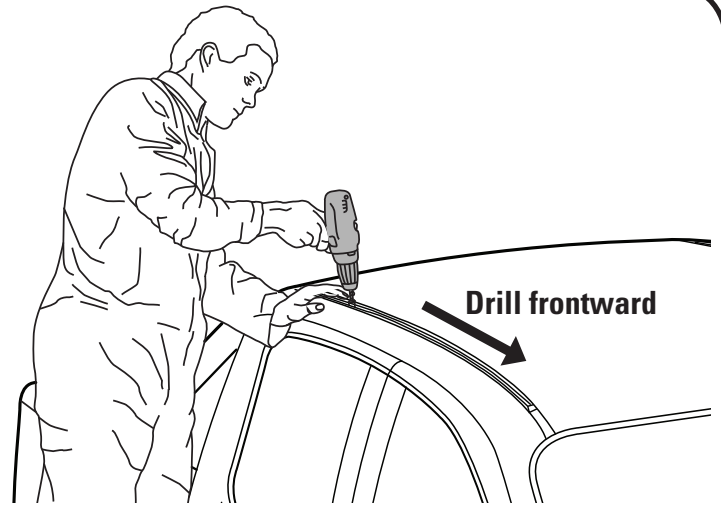
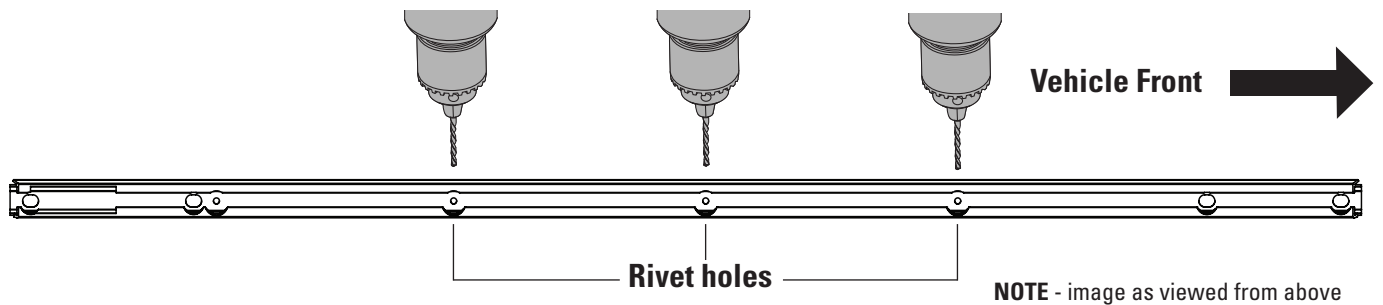
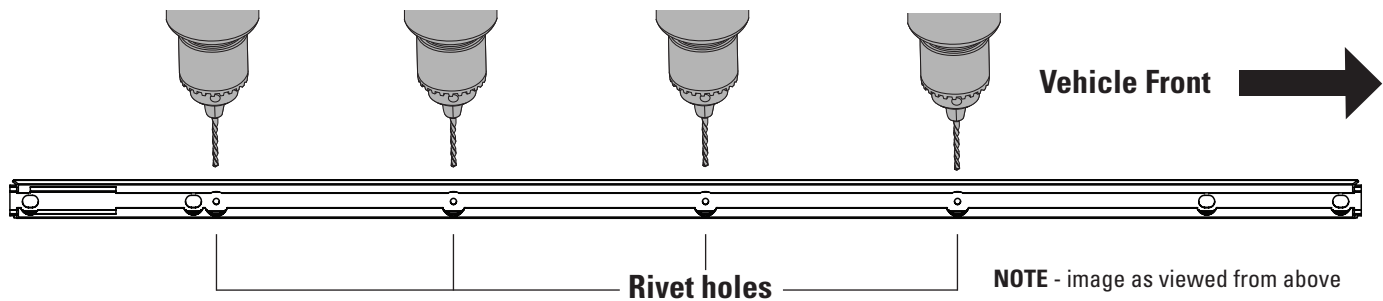
**Holden Colorado / Isuzu D-Max LS, LS-U, LS-M****Isuzu D-Max SX****11****DRILL ROOF CHANNEL**

All rivet holes can now be carefully drilled through. **To avoid drilling into roof lining a drill stop must be used.** The roof skin is approx. 2-3mm thick. **Ensure that a drilling angle perpendicular to the roof angle is maintained.**

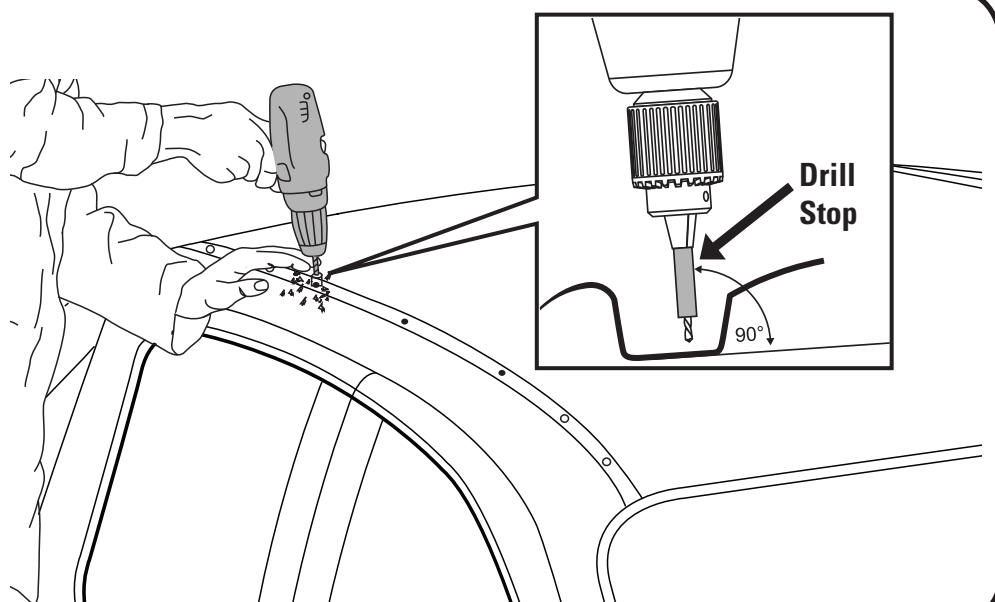

12 REMOVE SWARF

Avoid pushing swarf into the newly drilled holes by removing swarf from roof channel with a Vacuum Cleaner.

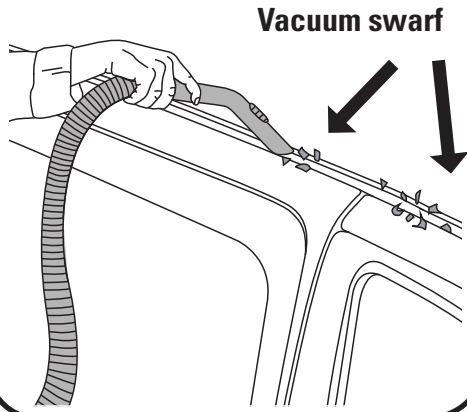

13 APPLY PROTECTIVE SEALANTS

Stage 1

Liberaly apply a Zinc Rich Cold Galvanising Solution to the inside surface and surrounds of each drilled hole. Allow solution to become touch dry before proceeding with Stage 2 (approx. 10 min depending on product used).

Stage 2

Liberaly apply a Mastic Silicone Sealant to the inside surface and surrounds of each hole, including the threaded M8 mounting holes.

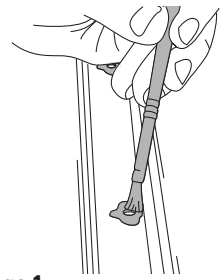

Stage 1

Apply liberaly in and around holes

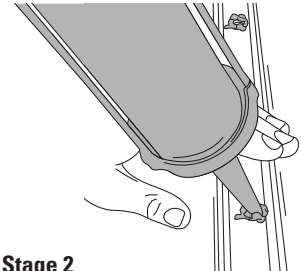

Stage 2

Apply liberaly in and around holes

14 PLACE TRACK BACK INTO ROOF CHANNEL

Accurately place Tracks over drilled holes in roof channel, ensuring Track orientation is correct as shown.

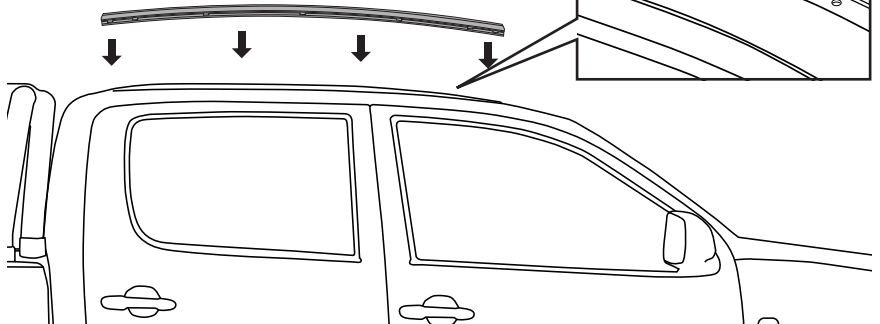
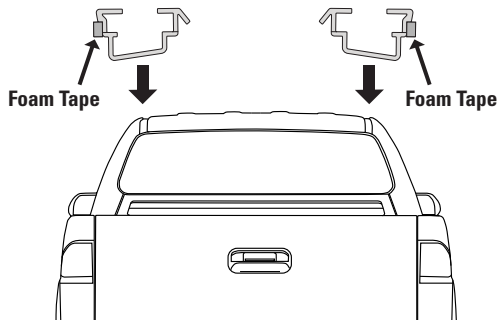

15 INSERT NUT PLATES

Run all of the M6 Hex Screws through the Nut Plates as shown. This will aid installation in Step 37.

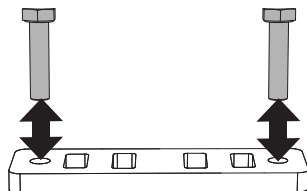

Slide Nut Plates into each Track end.

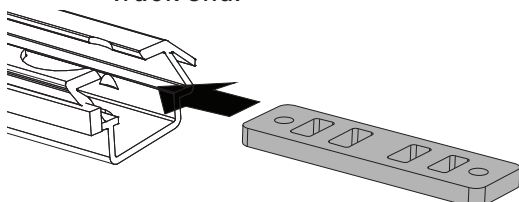

16 END CAP FITMENT

Assemble End Caps within Tracks as shown.

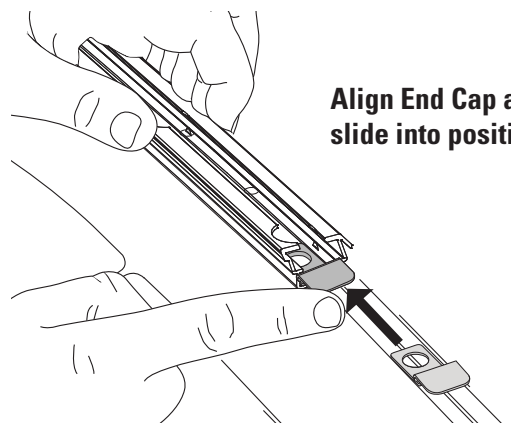
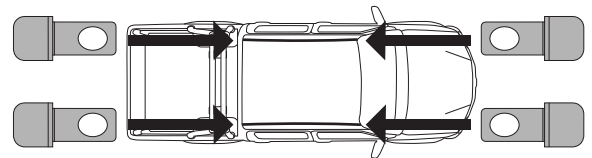

Align End Cap and slide into position

17

INSTALL M8 SCREWS AND SECURE END CAPS

Assemble 1 x M8 Spring Washer and 1 x M8 Washer onto each M8 Button Head Screw in the order shown and insert into the M8 Screw holes through Track. Tighten to 7Nm.

Holden Colorado / Isuzu D-Max LS, LS-U, LS-M

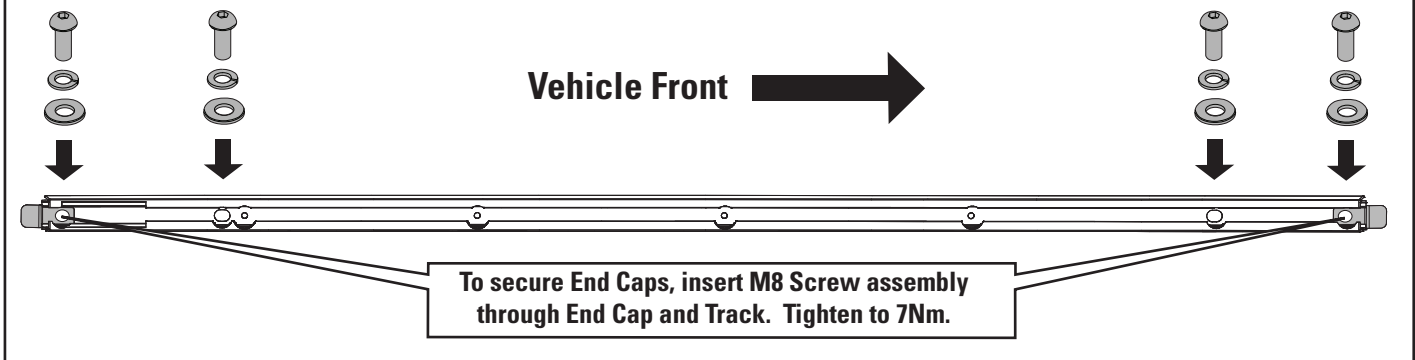

Isuzu D-Max SX

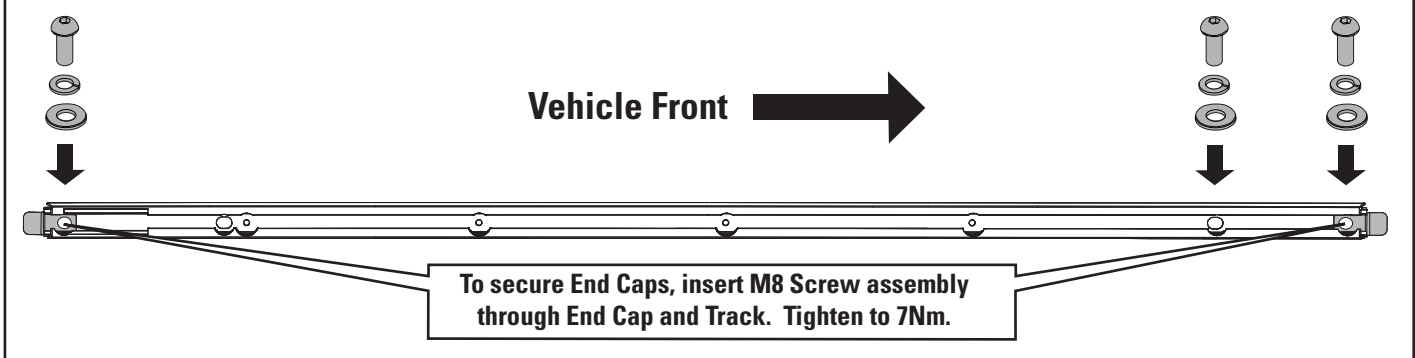

18

TRACK INSTALLATION

Align Track and insert all Rivets in their respective holes through Track into roof channel.

Using a Rivet Gun, punch each Rivet starting from the centre Rivet, then follow the numerical riveting order as shown.

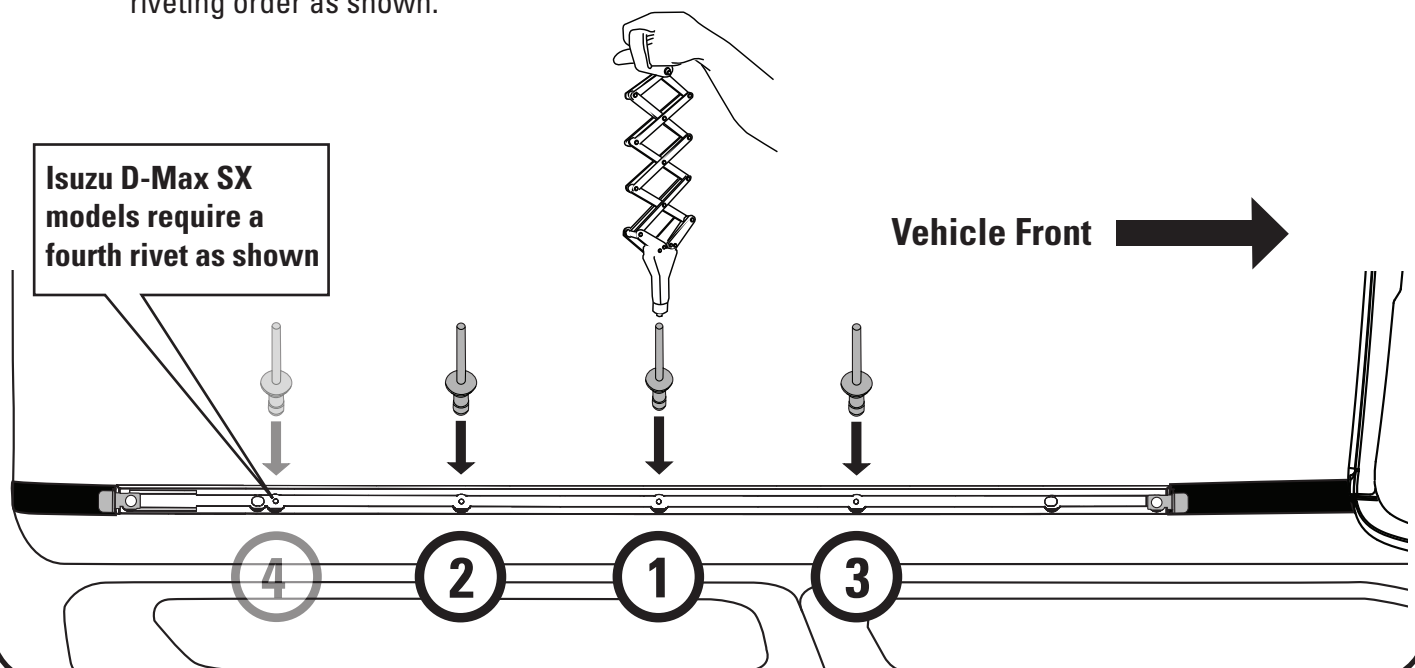

19

TRACK INSTALLATION COMPLETE

Check both Tracks are secured to the vehicle as per these installation instructions.
For assistance contact your local Yakima dealer.

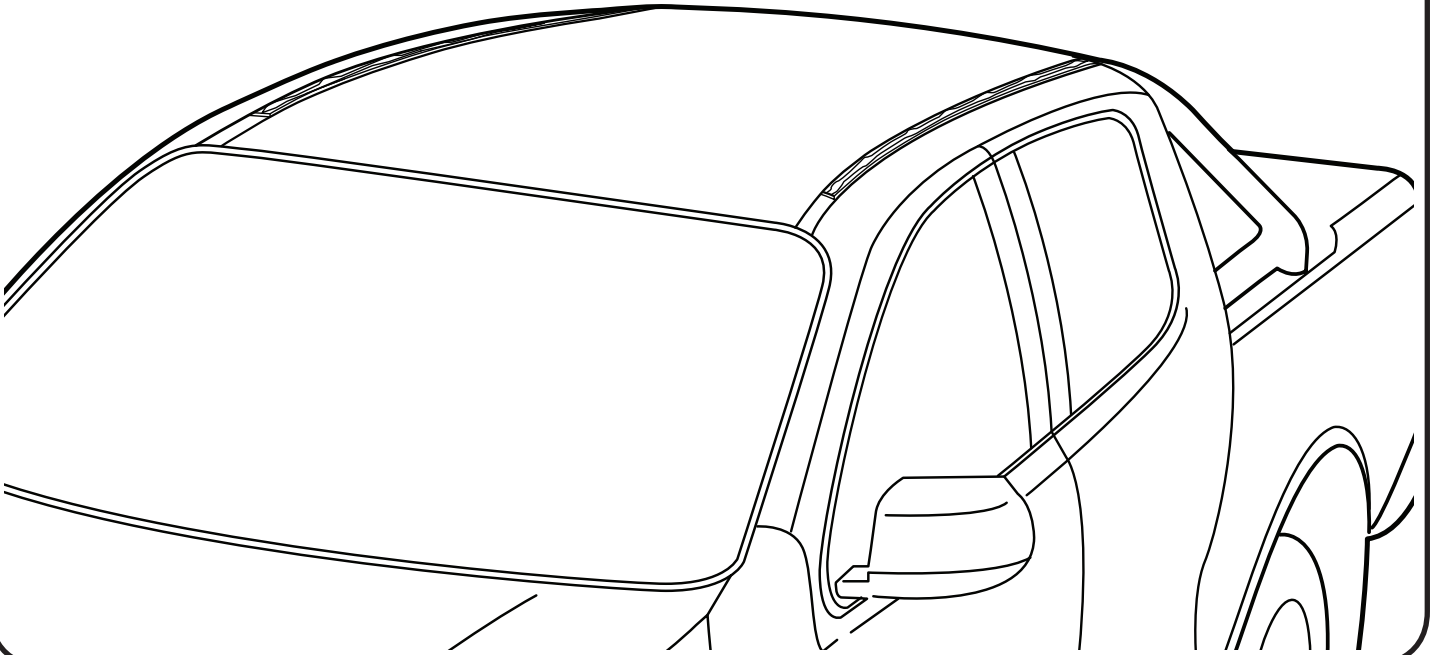

PLEASE SEE STEPS 20-42 ON PAGE 10 FOR BAR INSTALLATION

ISUZU D-MAX SX SUPPLEMENT STEPS

1A SPOT DRILL MOUNTING POINTS

Place Track into roof channel, ensuring Track orientation is correct as shown.

Using a 3mm Drill Bit (not supplied), spot drill the **centre** of the first, second and fourth M8 mounting points in the Track as shown. Ensure the Track does not move during this process by maintaining downward pressure on the Track while spot drilling holes. Use the help of an assistant if required. Once complete, remove Track taking care not to scratch vehicle.

Vehicle Front →

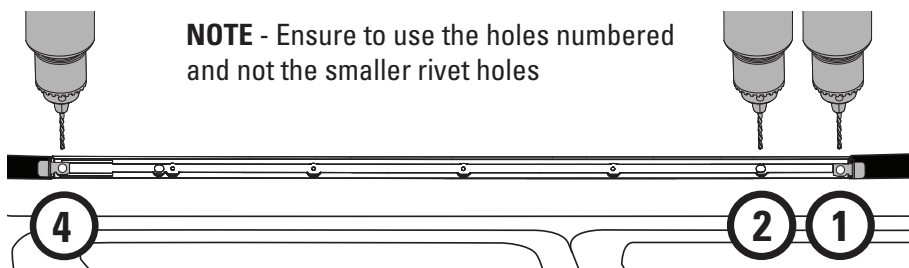
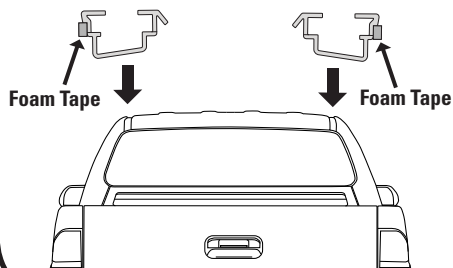

1B DRILL ROOF CHANNEL

The spot drilled Mounting Points can now be opened out using a 7mm Drill Bit (not supplied).

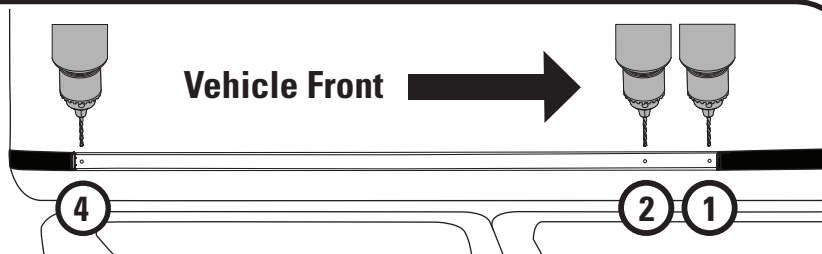

2 DIE GRIND HOLES

Die Grind the opened out holes from the previous steps. This will expose the M8 mounting points below.

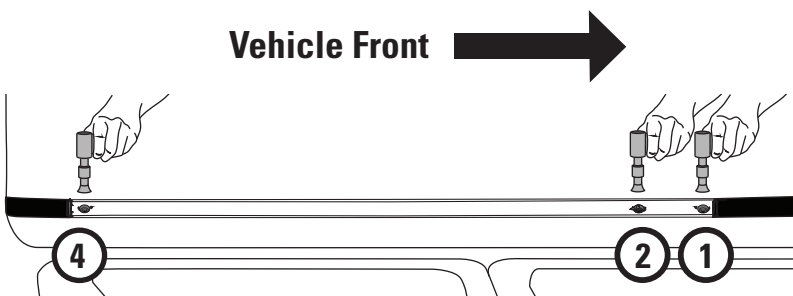

3 REMOVE SWARF

Avoid pushing swarf into the newly drilled holes by removing swarf from roof channel with a Vacuum Cleaner.

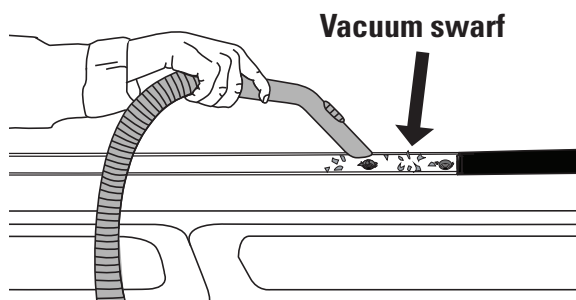

4 APPLY GALVANISING SOLUTION

Liberaly apply a Zinc Rich Cold Galvanising Solution to the inside surface and surrounds of each hole. Allow solution to become touch dry (approx. 10 min depending on product used).

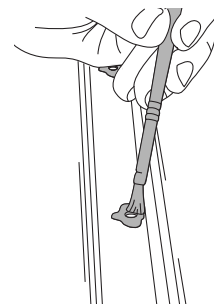

Apply liberaly in and around holes

5 GO BACK TO PAGE 4 AND FOLLOW STEPS 9 - 42 TO COMPLETE INSTALLATION

BAR INSTALLATION

20 REMOVE LEG COVERS

Using the keys supplied in the LOCKN'LOAD Leg Kit (sold separately), remove all Leg Covers.

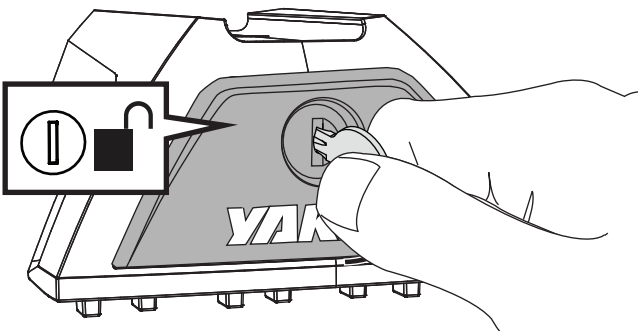

21 LEG ASSEMBLY

From the LOCKN'LOAD Leg Kit, position Nut Plates over holes on top of Legs.

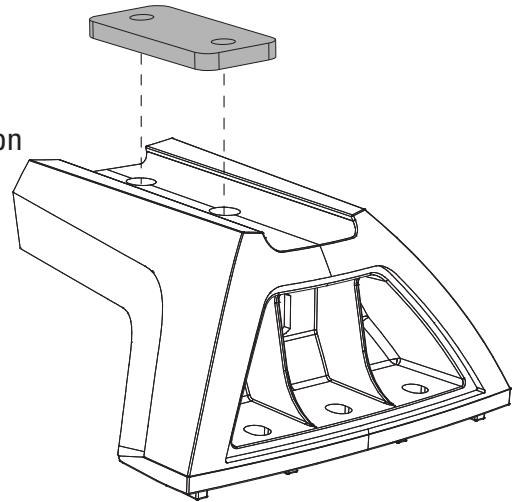

22 From the LOCKN'LOAD Leg Kit, assemble 1 x M8 Spring Washer and 1 x M8 Washer onto each M8 Set Screw 16mm in the order shown.

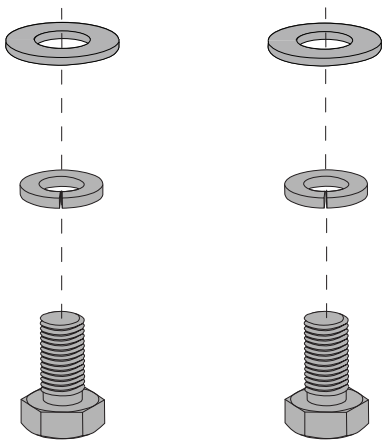

23 Loosely finger tighten Nut Plates to Legs as shown using the screw assemblies from the previous Step.

Ensure there is a sufficient gap between the Nut Plates and Legs for the next Step.

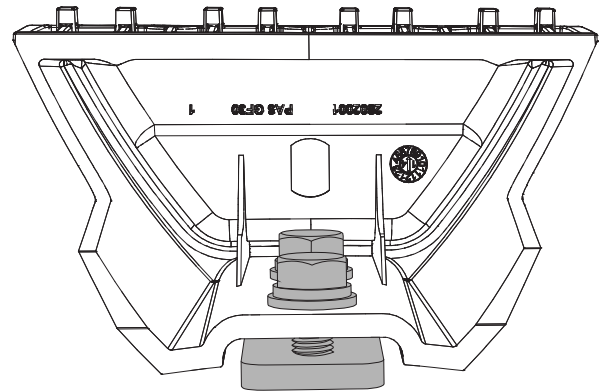

24 INSERT LEGS

Slide Leg assemblies into the underside channel of LOCKN'LOAD Bars (sold separately).

If Leg assemblies will not slide in, loosen Screws to increase gap.

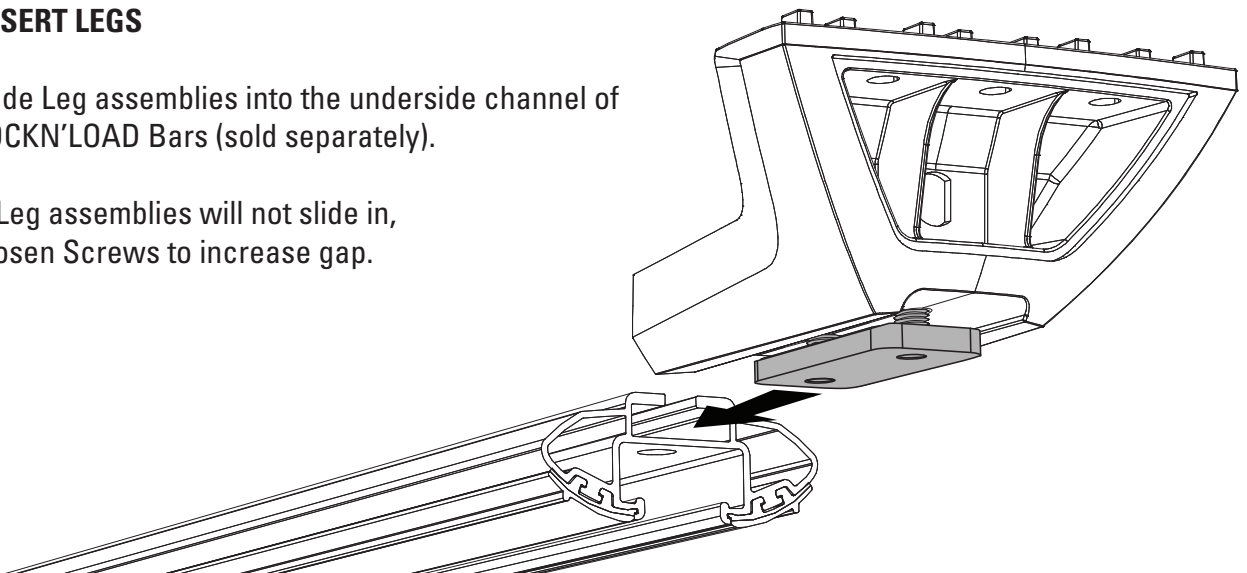

25 BAR LOCATION

IMPORTANT: Before beginning Bar installation, identify where along the Track you want the Front and Rear Bars fitted. We recommend a minimum of 700mm between Bars.

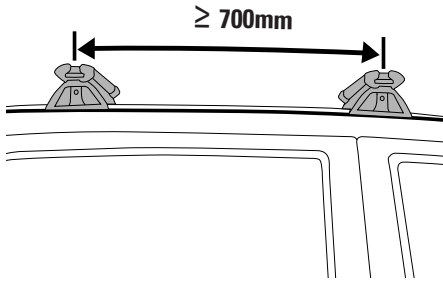

26 BAR PLACEMENT

Carefully place a Bar assembly over Track. **Take care not to damage vehicle.** Slide Legs along Bar until both legs are securely positioned within Track. Use a Tape Measure to ensure even Bar overhang on each side, re-adjust if required. Finger tighten one Screw on each Leg to secure Leg position along Bar. Repeat for remaining bar assembly then carefully remove Bars from vehicle.

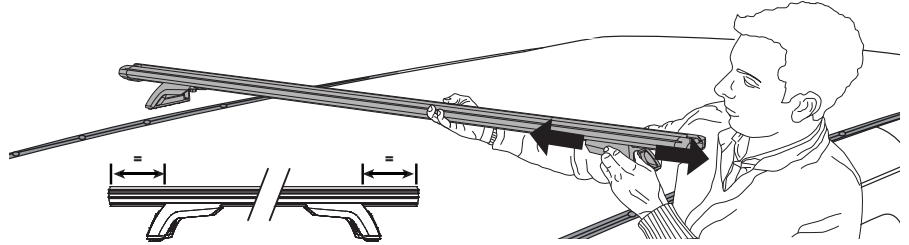

NOTE - Front and Rear Bars require individual adjustment due to tapered roof. Bars must be installed perpendicular to Tracks.

27 CHECK BAR SLOT MEASUREMENTS

Using a Tape Measure record Leg to underside slot distance of each bar in the table (right). Ensure measurement is taken from the centre of the Legs as shown. The ends of each bar should be the same measurement respectively, if not, repeat Step 26.

BAR SLOT MEASUREMENTS	
Front Bar (X)	Rear Bar (Y)
_____ mm x2	_____ mm x2

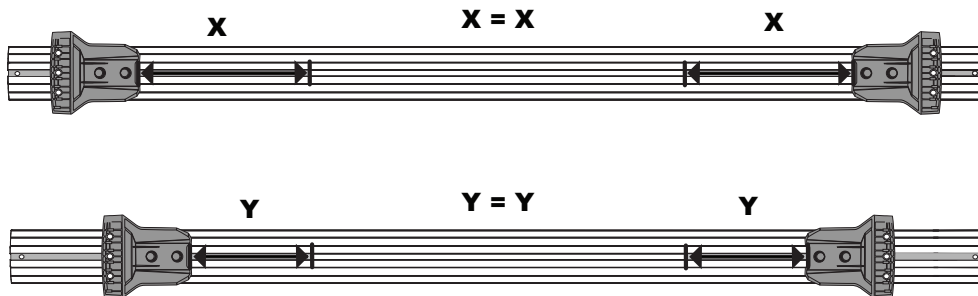

Remove Legs from Bar once equal measurement is obtained and recorded. Loosen the previously finger tightened screw on each leg, keeping Nut Plate and Screw assemblies in place as shown.

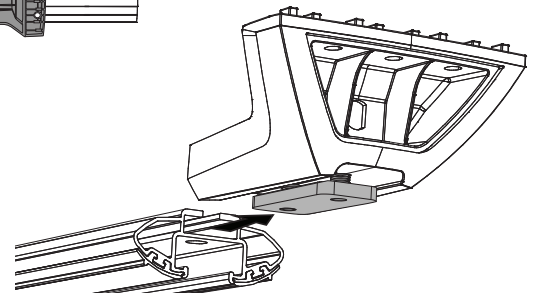

28 BAR SLOT COVERS

Cut Bar Slot Covers as per measurements recorded in the table above and insert into underside channel of front and rear Bar ends as shown.

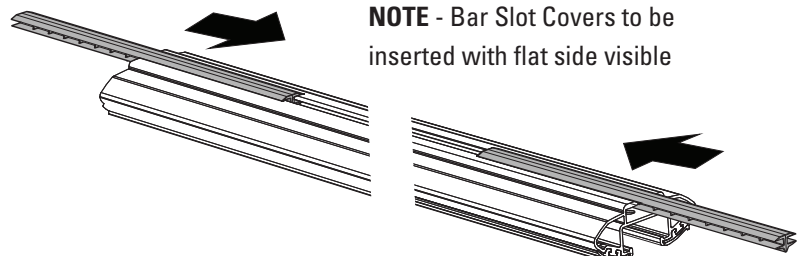
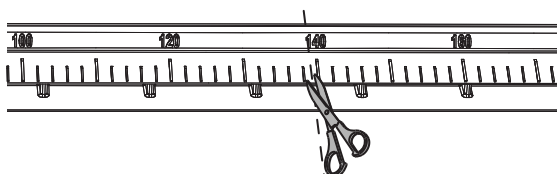

NOTE - Bar Slot Covers to be inserted with flat side visible

29**INSERT LEGS**

Slide Leg assemblies into the underside channel of LOCKN'LOAD Bars. Slide in until Leg reaches Slot Cover.

Do not compress slot cover.

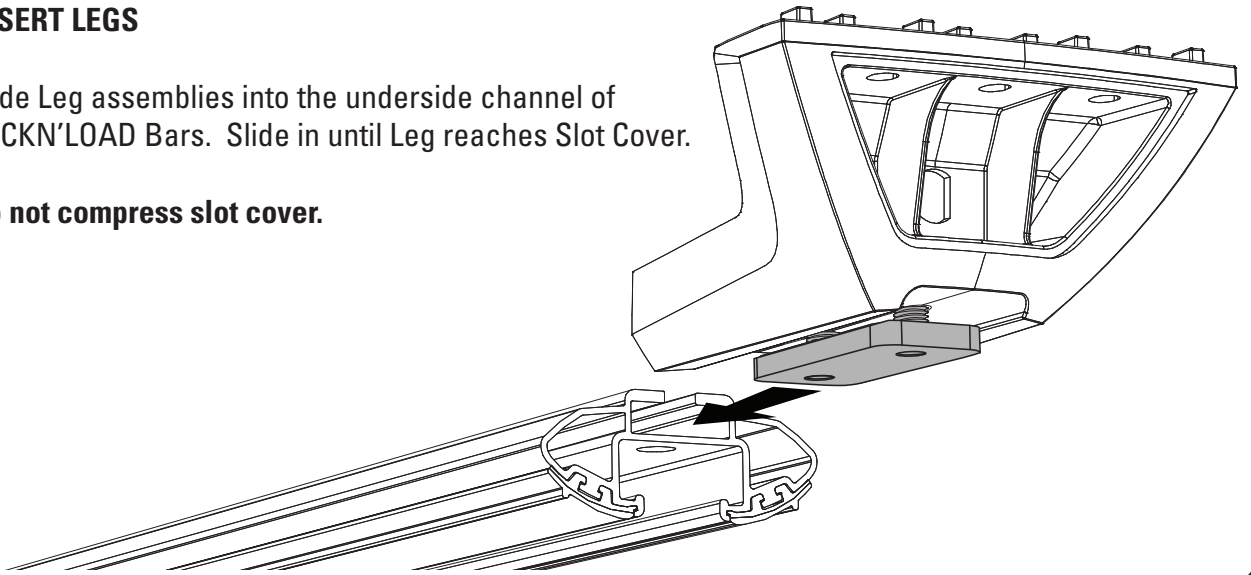
**30****SECURE LEGS TO BARS**

Tighten all M8 Set Screws to 7Nm using a 13mm Socket Wrench.

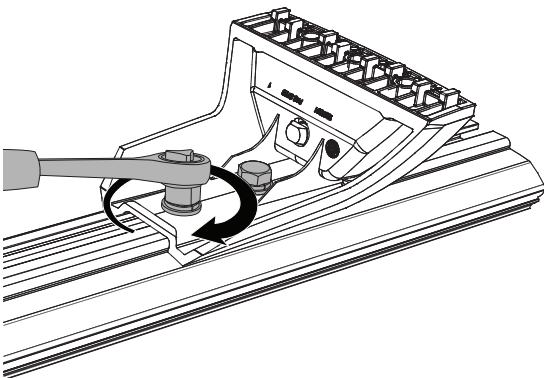
**31****BAR SLOT COVERS (OUTSIDE LEG)**

Measure the Bar channel outside of the Legs and subtract 20mm from this measurement. Using the remaining pieces of Slot Cover from Step 28, cut to this length and insert into the underside channel of each Bar end as shown.

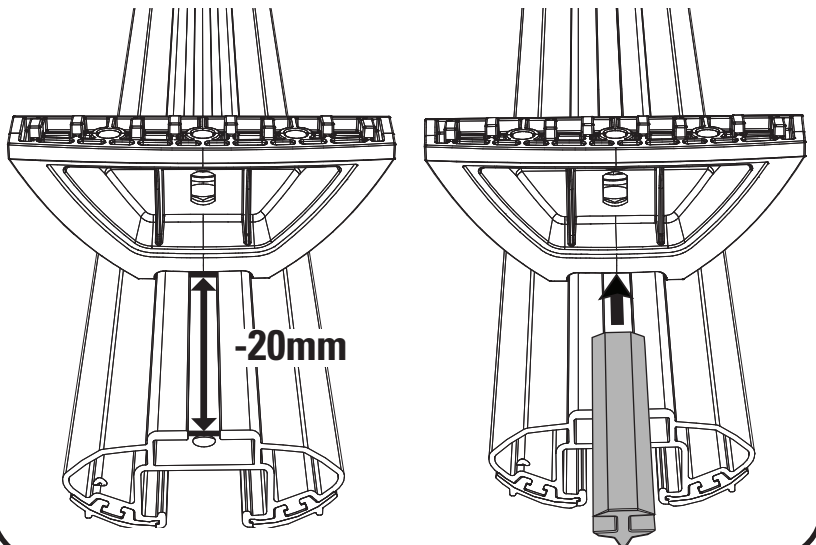
**32****END CAP ASSEMBLY**

From the LOCKN'LOAD Leg Kit, insert Bottle Openers and Pins into the End Cap Halves.

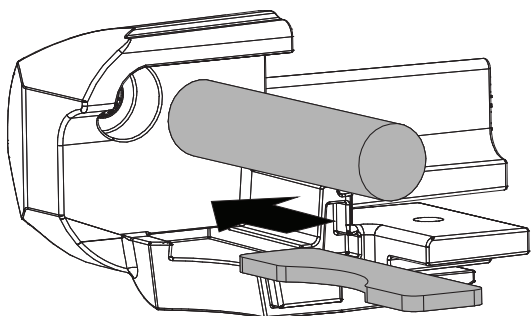
**33**

Connect all End Cap Halves together.

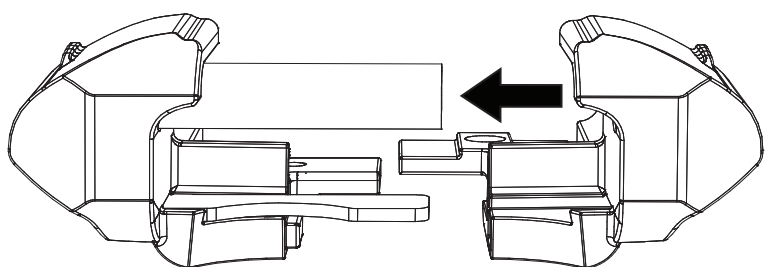

34**SECURE END CAPS TO BARS**

Insert the End Caps as shown. A Rubber Mallet can be used to assist installation.

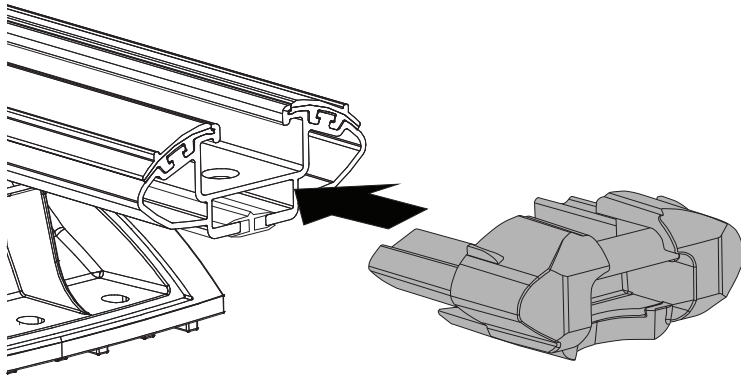
**35**

Secure using Plastite Screw (from LOCKN'LOAD Leg Kit). Tighten using a #2 Phillips Head Screwdriver.

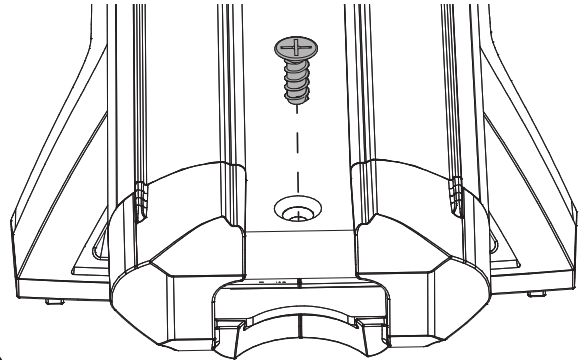
**36****BAR FITMENT**

Slide Nut Plates within Track into position for front and rear Bar placement. Place Bar assembly onto Tracks, carefully locating the four central raised notches on base of Legs into the cut outs on Nut Plates as shown. **Take care not to damage vehicle.** Repeat for remaining Bar.

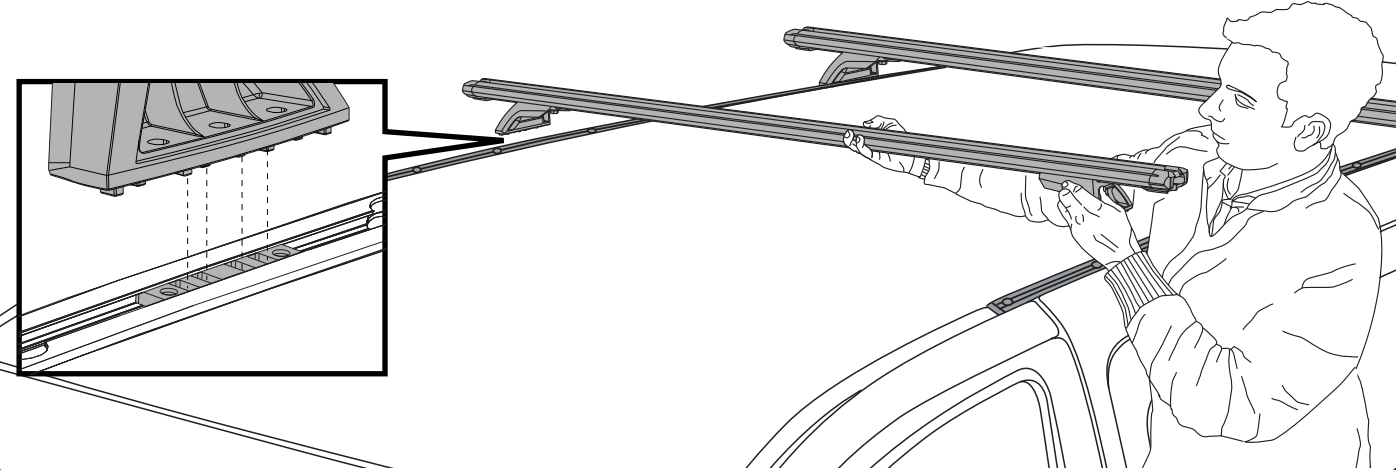
**37****SECURE BARS TO TRACKS**

From the LOCKN'LOAD Track Kit, assemble 1 x M6 Spring Washer and 1 x M6 Washer onto each M6 Hex Screw as shown. Insert through the outer holes on Legs into Nut Plate as shown. Finger tighten Screws.

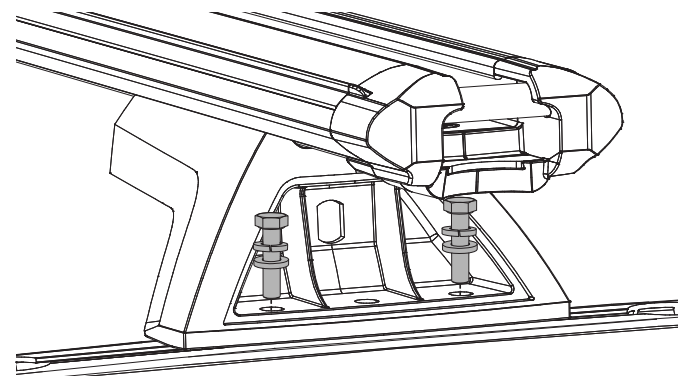
**38**

Place front and rear Bars back onto Track, ensuring there is a minimum distance of 700mm between each Bar. Measure from the centre of each Leg as shown.

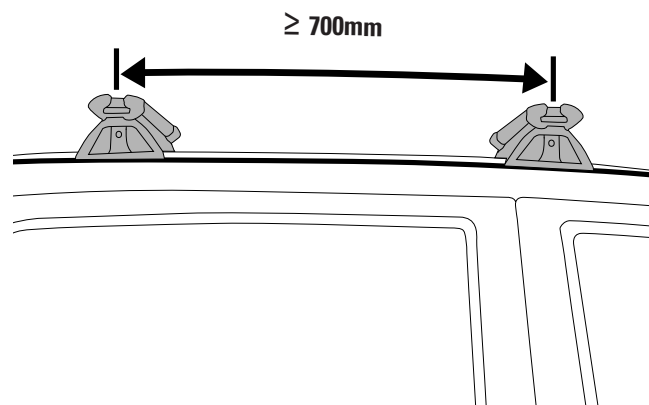

39

Tighten all M6 Hex Screws to 5Nm using a 10mm Open Ended Spanner

Do not over tighten.

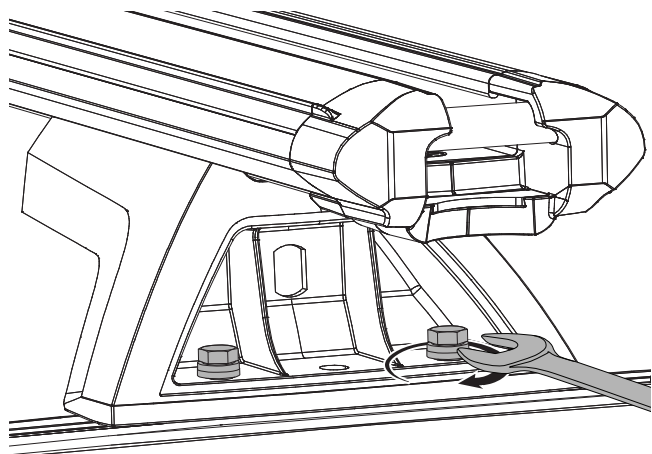
**40**

CHECK BAR LEGS ARE SECURE

Check all Bar Legs are secure.

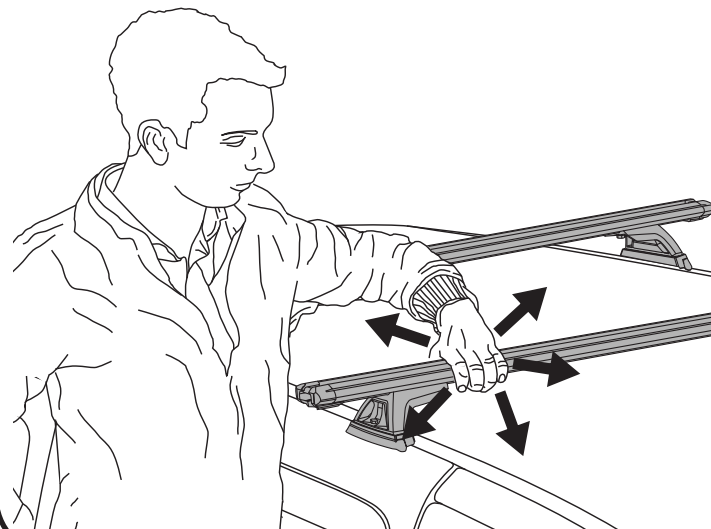
**41**

FIT LEG COVERS

Using the keys and Covers supplied in the LOCKN'LOAD Leg Kit, fit and lock all Leg Covers.

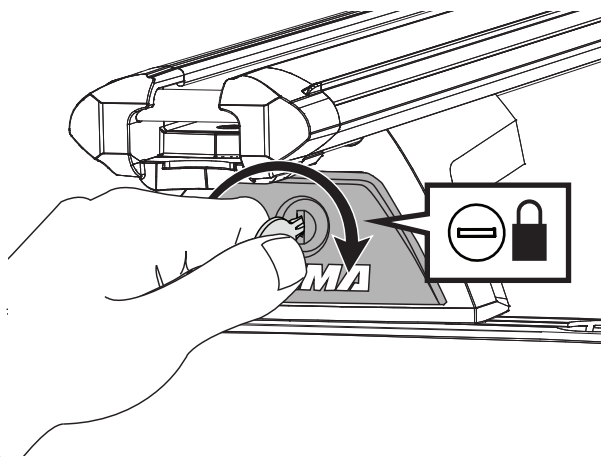
**42**

BAR KEYS

Place one key on the vehicle key ring and put the other away safely, or store with the spare vehicle key.

Write the key number (which is stamped on the key) in the box provided. Replacement keys are available from Yakima stockists, visit www.yakima.com.au or www.yakima.co.nz to find your nearest store or contact us directly on 1800 143 548 (AU) or 0800 4776 722 (NZ).

Key Number:
