



FITMENT INSTRUCTIONS

ModCap & Canopy Camper Water Tank Kit (CC-A-WT-KIT-V2)

DISCLAIMER

Preliminary information

All rights reserved. No part of this document may be reproduced, translated, stored in a retrieval system. Or transmitted, in any form or by any means, electronic., mechanical, photocopying, recording or otherwise, without prior written permission of the owner.

Review all instruction information carefully before installation.

Any damages, direct or indirect to the installer and/or property due to incorrect installation of any parts are the responsibility of the installer. Due to the various

application and firmment options available, the responsibility lies with the user to ensure all mounting points are secure and tight before every trip. If unsure, consult with your Distributor regarding the operations of our products.

Users are advised to be mindful of the load they are carrying and drive in accordance with road conditions.



Service Enquiries email
queries@alu-cab.com

Installation Instructions

The tables below show the equipment, i.e. tools and fasteners required to install the Canopy Camper Water Tank Kit .

1

Tools & Items Required	
2X13MM SPANNERS	THREAD TAPE
13MM SOCKET AND RATCHET	DRILL
FLAT SCREW DRIVER	20MM DRILL BIT
PHILLIPS SCREWDRIIVER	HOLE SAW

Fasteners Supplied	Qty
M8 NYLOC NUT S/S	32
M8 NUT CAPS	32
M8 FLAT WASHER S/S	32
M8 X 25 HEX BOLT S/S	9
M8 X 20 CUP SQUARE BOLTS S/S	16
M8 X 16 HEX BOLT S/S	8

Hardware Required	DESCRIPTION	Qty
CC-A-WT-PLB	WATER TANK	1
PVC-PLUG-12	1/2" NPT PLUG (MALE)	3
442-UNI-MNT-KIT-ASSY-00	MOUNTING KIT - UNIVERSAL	1
442-BRE-ASSY-00	BREATHER ASSEMBLY	1
442-UNI-KIT-TAP-ASSY-01	TAP ASSEMBLY	1

Please be sure to lay out all parts provided on a table or flat surface in order to check that all required parts are accounted for and prevent potential frustration at a later stage.

Component Identification (Not to Scale)

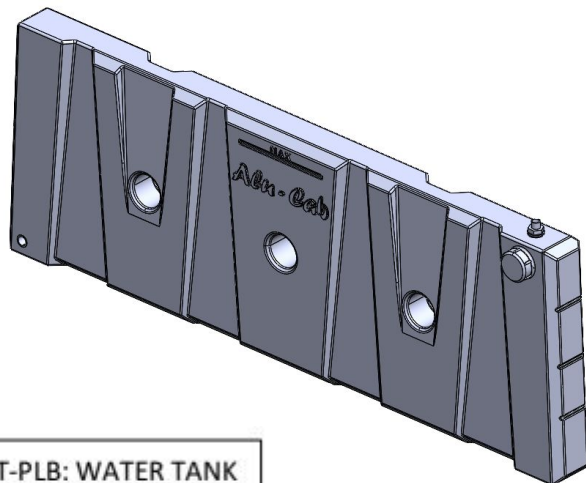

CC-WT-PLB: WATER TANK
X1



442-UNI-MNT-KIT-ASSY-00:
MOUNTING KIT - UNIVERSAL
X1

442-BRE-ASSY-00:
BREATHER ASSEMBLY
X1



PVC-PLUG-12:
1/2" NPT PLUG (MALE)
X3



442-UNI-KIT-TAP-ASSY-01:
TAP ASSEMBLY
X1

Installation Instructions

STEP 2

Plug installation

The first step to install the Canopy Camper Water Tank Kit is to fit the 3 supplied Plugs to the 3 Outlets that you will not be using for your Tap Assembly, on the Water Tank. Add thread tape or thread to the Plug and screw them into the 3 unused Outlets

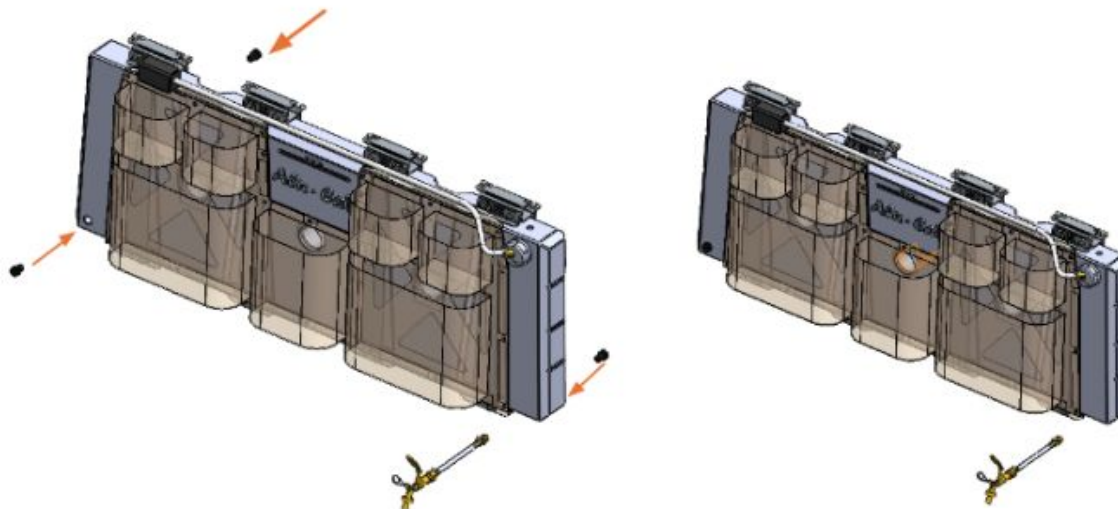

Installation Instructions

STEP
3

Top Mounting Brackets

The next step to install the Canopy Camper Water Tank Kit is to fit and assemble the Top Mounting Bracket assembly:

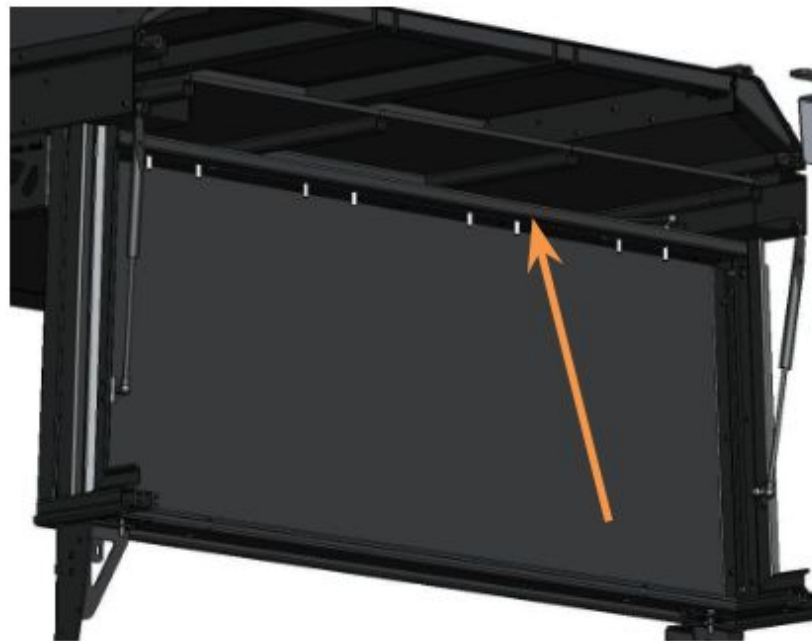
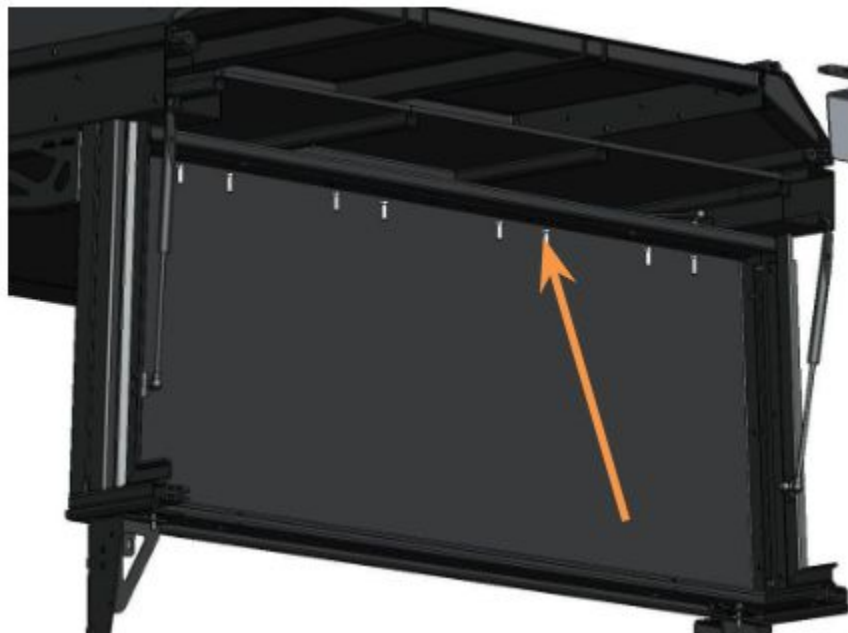

Insert 8x M8x25 Hex Head Screws into the top Front Load Bar Frame Nut Slot of the Canopy Camper

Installation Instructions

Place the Top Mounting Brackets corresponding with the M8x25 Hex Head Screws.

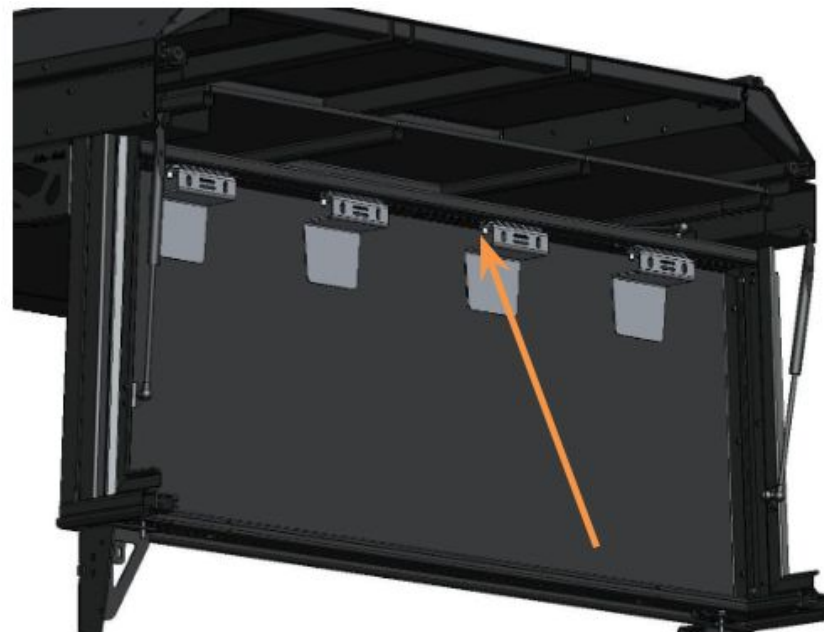
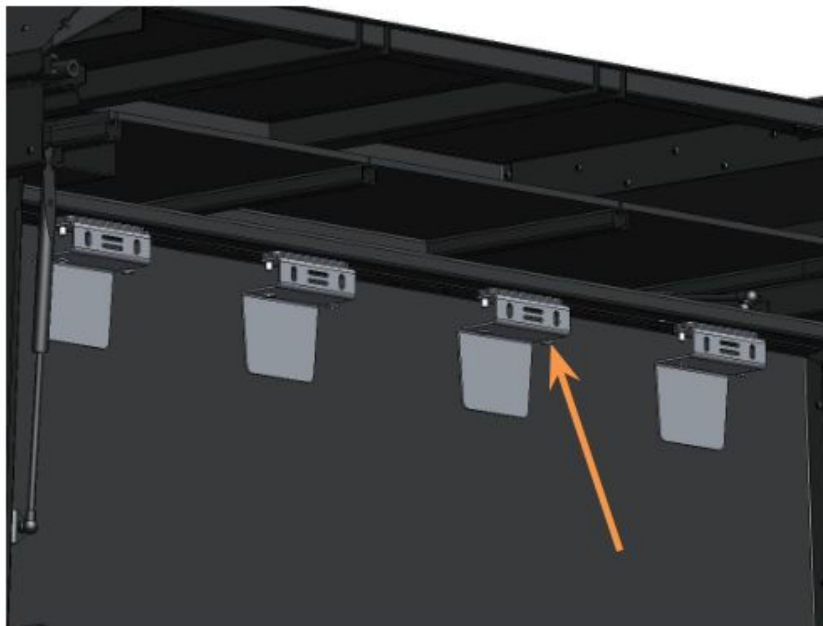

Installation Instructions

Place M8 Flat Washers on the M8x25 Hex Head Screw Shafts

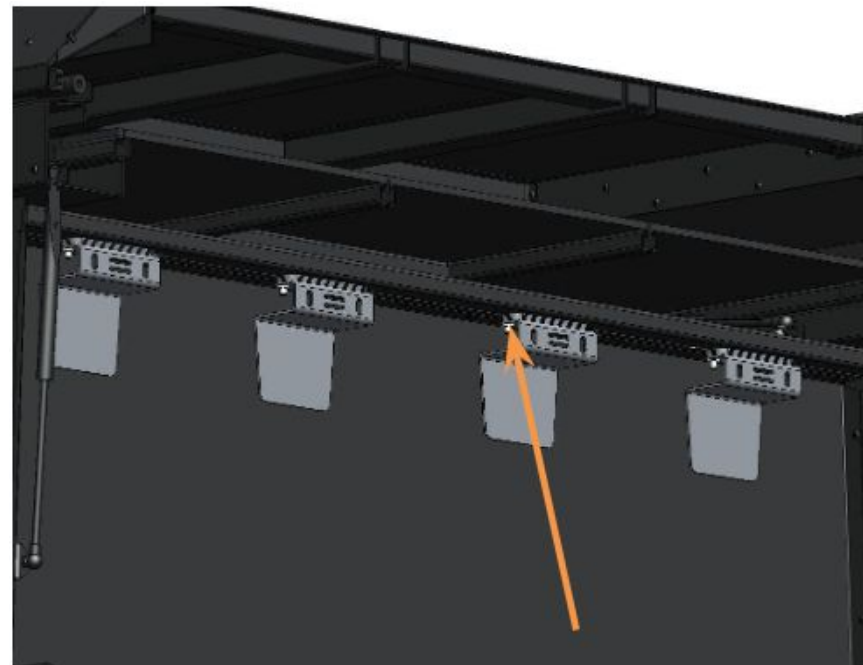
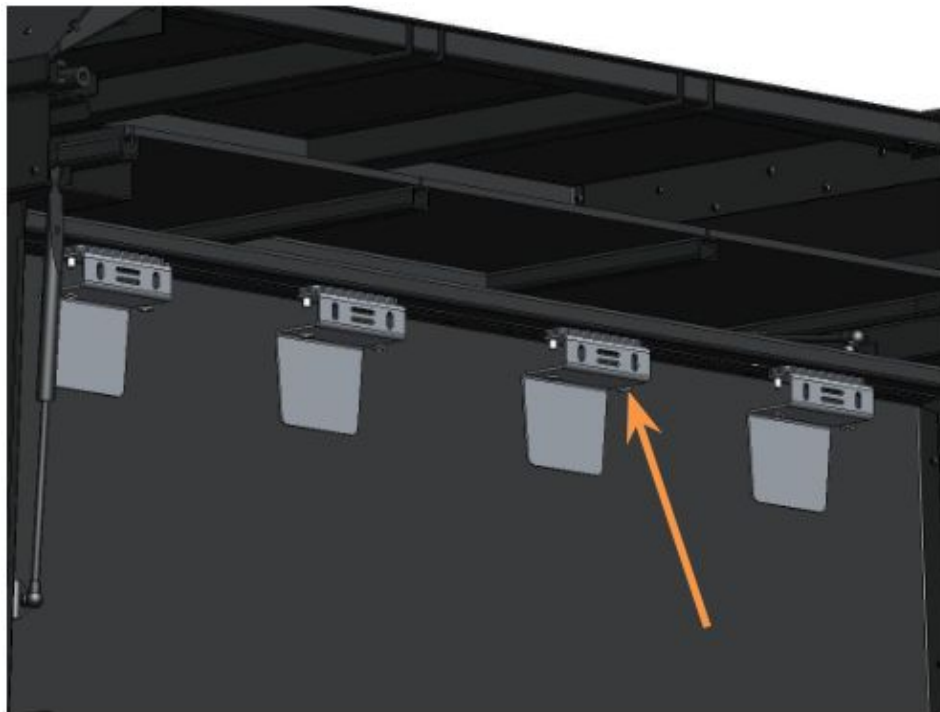

Installation Instructions

Loosely secure the Top Mounting Bracket assembly with the provided M8 Nyloc Nuts

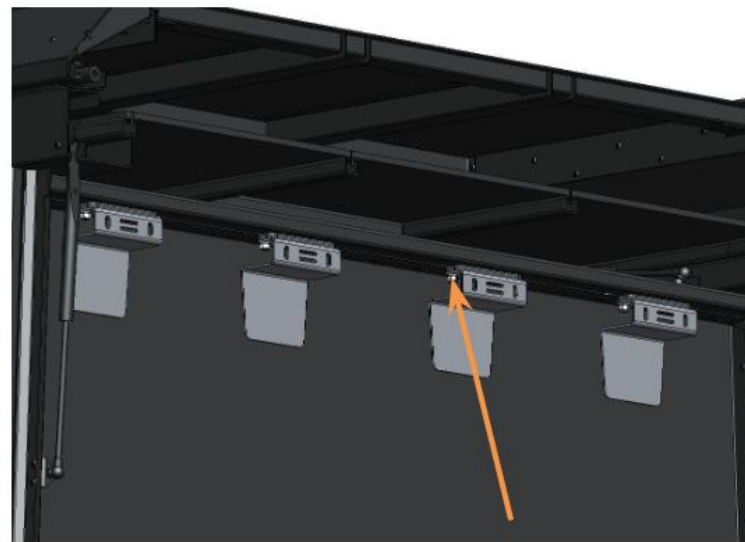
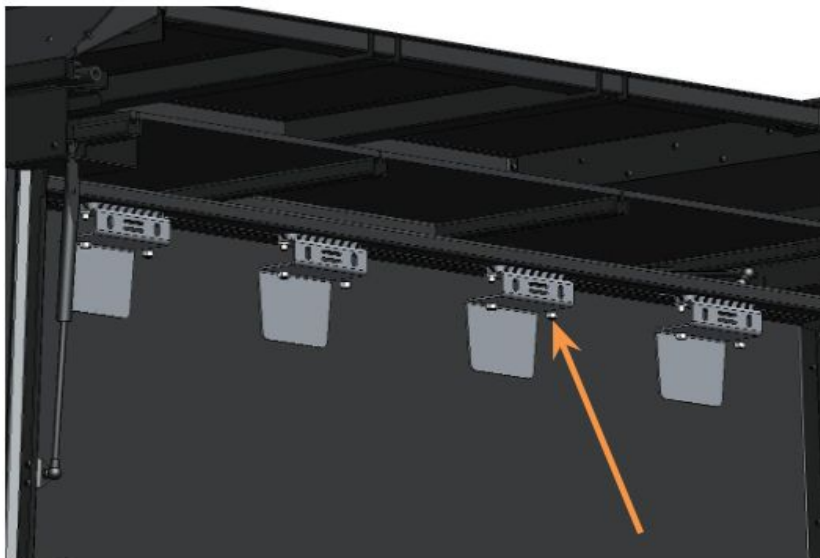

Installation Instructions

STEP
4

Bottom Mounting Brackets

The next step to install the Canopy Camper Water Tank Kit is to fit and assemble the Bottom Mounting Bracket assembly:
Insert 8x M8x16 Hex Head Screws into the bottom Front Load Bar Frame Nut Slot of the Canopy Camper

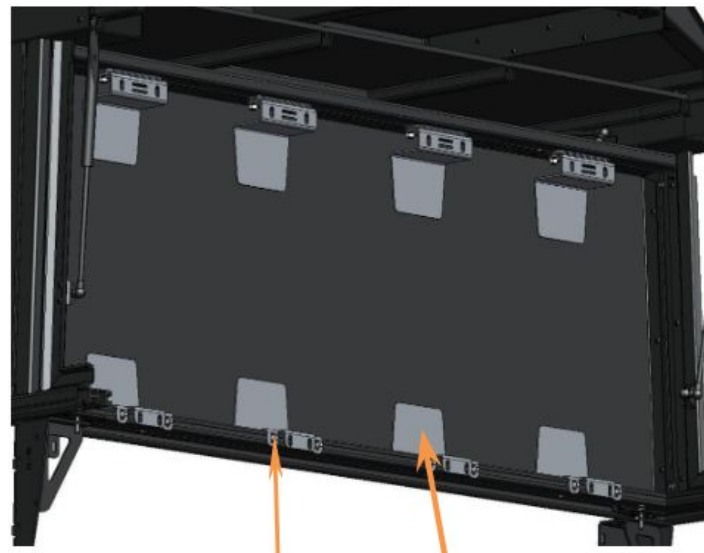
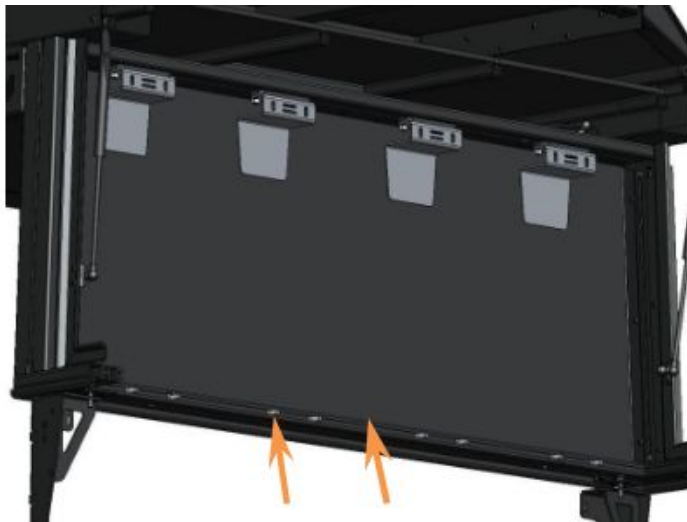

Place the Bottom Mounting Brackets with the corresponding M8x16 Hex Head Screws

Installation Instructions

Place M8 Flat Washers on the M8x16 Hex Head Screw Shafts.

Loosely secure the Bottom Mounting Bracket assembly with the provided M8 Nyloc Nuts

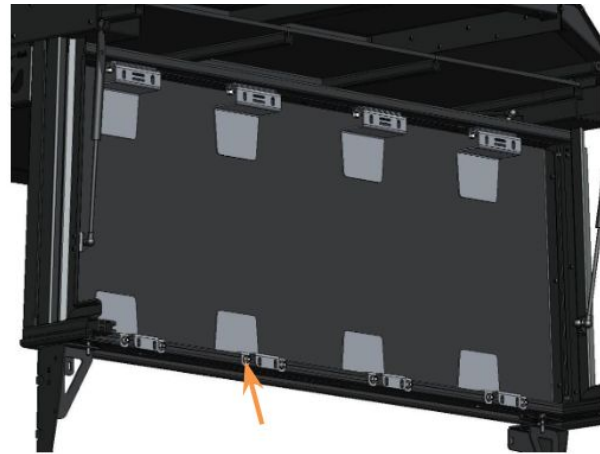
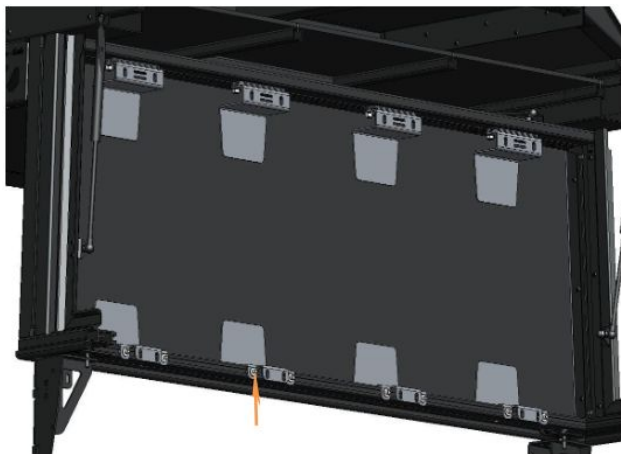

Installation Instructions

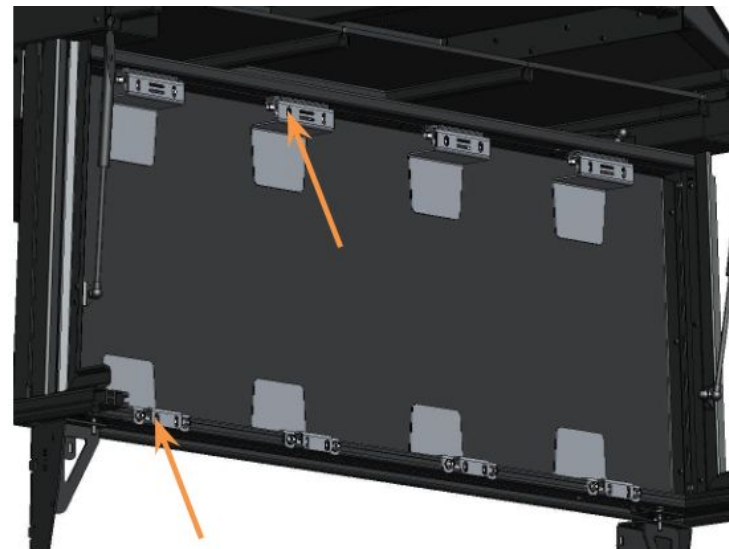
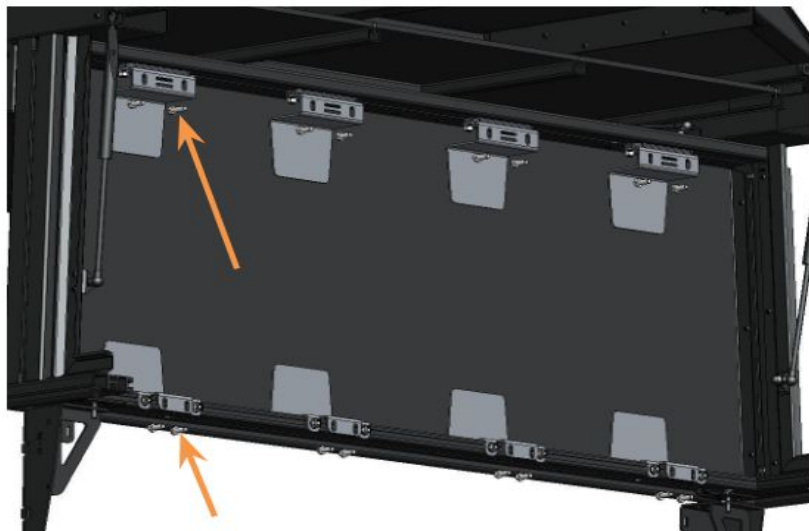

Installation Instructions

Insert 16x M8x20 Cup Square bolts into the shown slots

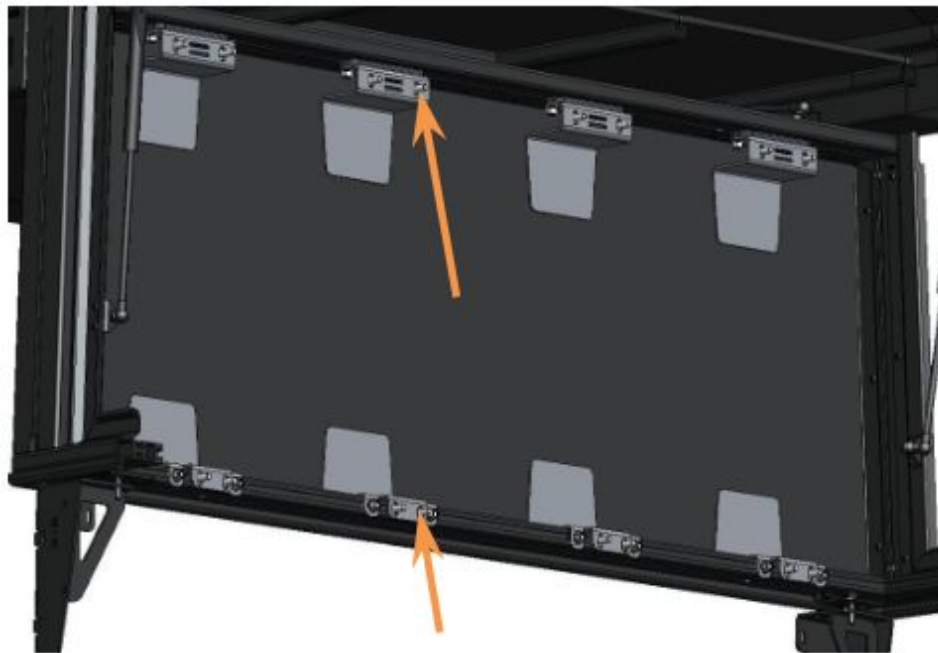

Tank and Top Down Mounting Brackets

NB - If you have purchased the Canvas Bag Assembly, refer to Fitment Instruction [CC-A-WT-CB-KIT](#) for the final steps.

The next step to install the Canopy Camper Water Tank Kit is to fit and assemble the Top Down Mounting Bracket assembly and place the Water Tank



Place the Water Tank as shown

Installation Instructions

Place the Top Mounting Down Brackets over the Water Tank, between the Tank Ridges, as shown.
Shift and position the Bottom, Top and Down brackets to correspond and align centrally with the Water Tank recesses



Installation Instructions



Place 7x M8 Flat Washers on the corresponding M8 Screws as shown (Leave one fastener open, as this will be the Breather Assembly mounting location - The ideal location is indicated with a circle above.)

Installation Instructions

Secure the Top Mounting Down Brackets at the top using 7x M8 Nyloc Nuts. Add 8x M8 Nut Caps to complete the fastener stack ups. (Leave one fastener open, as this will be the Breather Assembly mounting location - The ideal location is indicated with a circle above.)



Installation Instructions

Secure the Top Mounting Down Brackets at the bottom using 8x M8 Flat Washers and 8x M8 Nyloc Nuts as shown above. Add 8x M8 Nut Caps to complete the fastener stack ups.



Installation Instructions

STEP
6

Breather Assembly

The next step to install the Canopy Camper Water Tank Kit is to fit the Breather assembly. Both old and new brackets are included in the kit. Place the Breather Assembly in the desired location, and secure in place, using the fastener stack up indicated in the image below. (M8 Flat Washer, M8 Nyloc Nut & M8 Nut Cap).

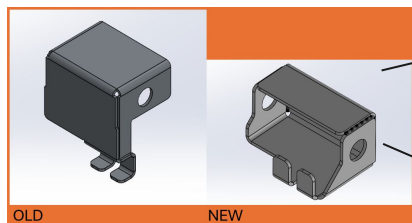

You will need to use
the **NEW** Bracket for
ModCap Canopy/
Fixed roof and Family
Camper

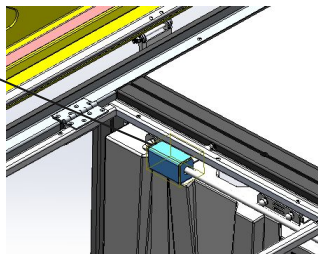

You can use either **OLD** or **NEW**
Bracket for the Canopy Camper
and the ModCap Tent.

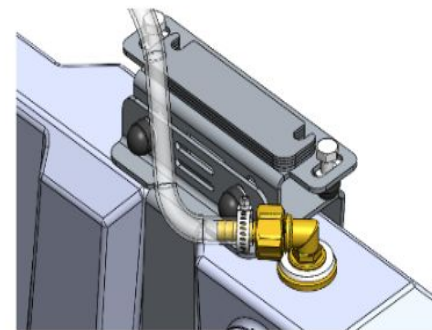
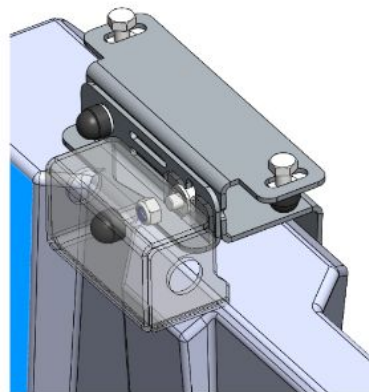

Connect the 90 Degree Elbow to the outlet fitting on the Tank Assembly, as shown in the image above. Ensure to add Thread Tape to the interface between the two fittings.

STEP
7

Water Tank Tap Assembly

The last step to install the Canopy Camper Water Tank Kit is to fit the Tap Assembly:

Add thread tape to the Male threaded hose fitting on the Tap Assembly and screw it into the desired Outlet on the Water Tank. Next, using your Drill, drill a 20mm hole in the desired location for your Tap, unscrew the Tap from its hose connector and screw it back through the drilled hole, sealing with thread tape or thread sealant. A 3m length of hose has been supplied to access most applicable locations for your tap mounting location.



Installation Instructions

The image below shows an example of a rear mounted tap assembly, where the hole has been drilled through one of the rear filler panels:

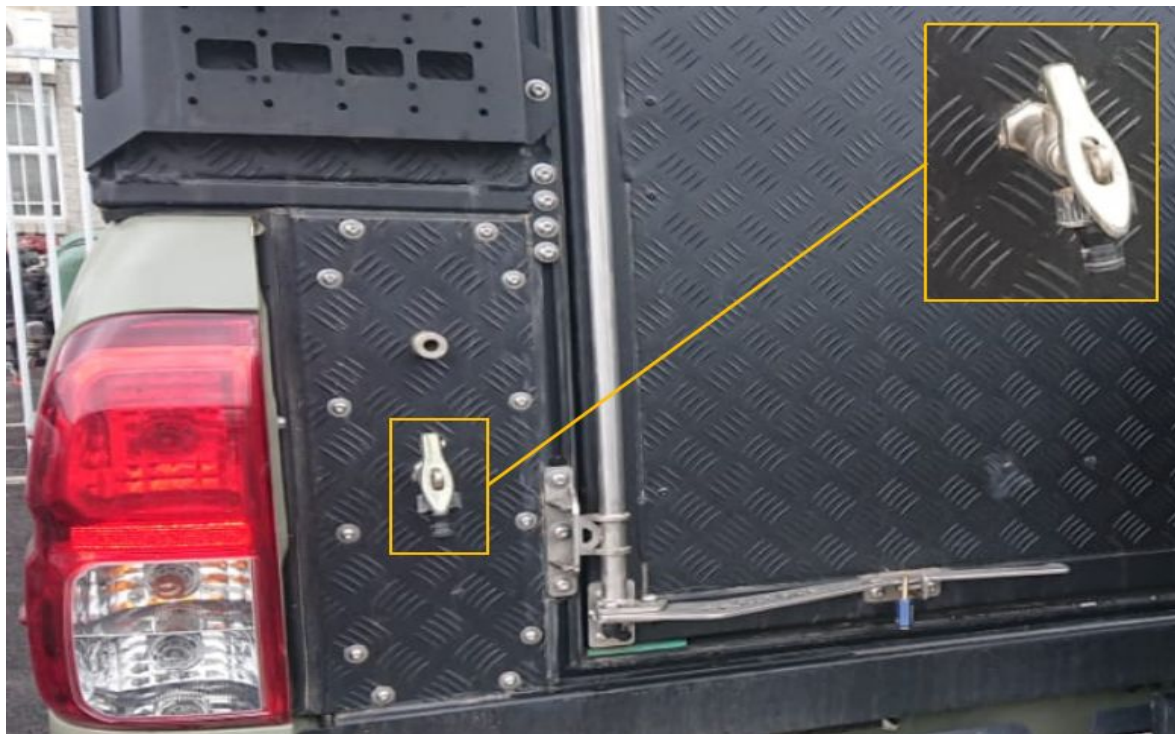

Disclaimer

All rights reserved. No part of this website may be reproduced, translated, stored in a retrieval system, or transmitted, in any form or by any means, electronic, mechanical, photocopying, recording or otherwise, without prior written permission of the owner.

Review all instructions information carefully before installation.

Any damages, direct or incidental to the installer and/or property due to incorrect installation of any parts are the responsibility of the installer. Due to the various applications and fitment options available, the responsibility lies with the user to ensure all mounting points are secure and tight before every trip.

If unsure, consult with your Distributor regarding the operations of our products.

Users are advised to be mindful of the load they are carrying and drive in accordance with road conditions.

WARNING

Always wear appropriate PPE (Personal protection equipment) when fitting our products. Although the mounting kit is designed to be DIY, if you have any doubts or concerns, contact an accredited fitment centre to carry out the work. Alu-Cab will not be liable for any injury to persons, and/or damage to products and/or vehicles.

While Alu-Cab Holdings takes reasonable measures to ensure that the contents of this Website are accurate and complete, Alu-Cab Holdings makes no representations or warranties, whether express or implied, as to the quality, timeliness, operation, integrity, availability or functionality of this Website or as to the accuracy, completeness or reliability of any information on this Website. Alu-Cab Holdings reserves the right to make changes, corrections and/or improvements to the information and to the products and programs described in such information, at any time without notice.

Alu-Cab Holdings will use reasonable endeavours to maintain the availability of the Website, except during scheduled maintenance periods, and reserves the right to discontinue providing the Website or the service or any part thereof with or without notice to you. Any person who accesses this Website or relies on this Website or on the information contained in this Website does so at his or her own risk.

Occasionally, at our discretion, we may include or offer third-party products or services on our website. These third-party sites have separate and independent privacy policies. We therefore have no responsibility or liability for the content and activities of these linked sites. Nonetheless, we seek to protect the integrity of our site and welcome any feedback about these sites.