



---

## AIR COMPRESSOR BRACKET INNER GUARD

---

TLR682110

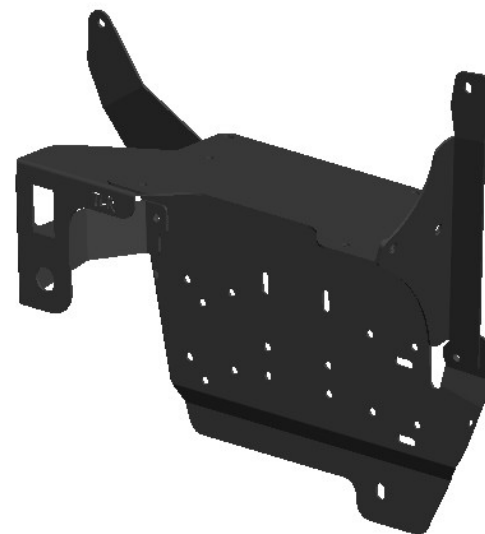

[hello@tlrproducts.com.au](mailto:hello@tlrproducts.com.au)  
[www.tlrproducts.com.au](http://www.tlrproducts.com.au)



[instagram.com/tlrproducts](https://www.instagram.com/tlrproducts)  
[facebook.com/tlrproducts](https://www.facebook.com/tlrproducts)

SUITED TO:  
**TOYOTA LANDCRUISER LC250 (EU Spec)**



Read through this installation guide before proceeding



Fitting time is approx. 45 minutes.



Spanner, socket set, Trim Removal tool, Body Saw or Multitool.

#### FITTING KIT

QUANTITY	PART
1	TLR682110-1 Main Compressor Bracket
1	TLR682110-2 Switch and Coupling Mount
1	TLR682106-1 Tank / Upper Bracket
1	TLR682106-2 High Mount Coupling Bracket
1	TLR682106-4 Brace
1	M8 x 20 Buttonhead Socket Screw SS
1	M8 Nyloc Nut SS
2	M8 x 17 x 1.2mm Flat Washer SS
2	M6 x 20 Buttonhead Socket Screw SS
9	M6 x 16 Buttonhead Socket Screw SS
6	M6 x 12.5 x 1.2mm Flat Washer SS
2	M6 Spring Washer SS
9	M6 Nyloc Nut SS
1	JIC4(M) – ¼" NPT(M) Elbow #0740110

Other components required for complete fitment:

- 1x ARB Hose Reinforced JIC4 x 300mm #0740201.
- 1x ARB Elbow JIC4 #0740104.
- 1x ARB Pump Up Kit STD high Temp V2 Orange #171302V2.
- 1x ARB Air Coupling #0740111
- 1x ARB Air Compressor of Choice.



11. Install the JIC4(M) x ¼" NPT fitting supplied with kit to the outlet of the compressor.
12. If installing an air tank do so at this point using the supplied M6x16 Bolts, Nyloc Nuts and Flat washers. Install the switch and coupling. Complete all plumbing and wiring of the compressor, you will need to use a 90-degree elbow fitting for the coupling.
13. Working on the back side of the plastic interior trim panel, drill out the rivets holding the compartment box in place and remove the box. Photo 8.
14. Re install all interior trim components to complete the installation.



Sample Image of High Mount .



## FITTING INSTRUCTIONS

1. Remove the LH side rear interior trim panel to access the inner guard area. This is done by removing the 3 x M6 mounting bolts from the locations shown **blue**, Removal of 2<sup>nd</sup> row seatbelt bolt shown in **red**, and rubber door seal around rear and passenger door section. Refer to Photo 1



2. Remove both the rear and left-hand side floor trim panels to expose the lower section of the interior trim panel.
3. Carefully unclip the trim panel from the body by pulling the panel away from the body to release the plastic retaining clips.
4. Prior to complete removal of the panel, ensure to unplug the electrical plugs for both the power outlet and the rear interior light.

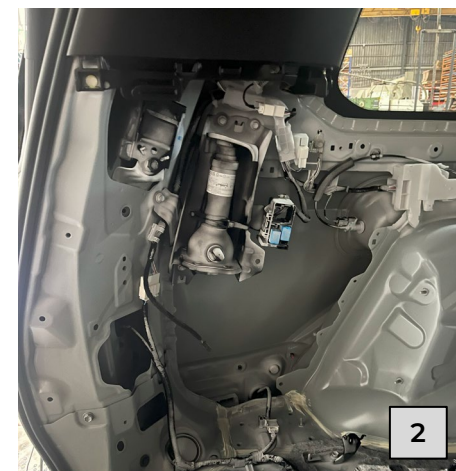





5. Refer to Step 5a. If installing Air compressor only OR 5b. if also installing the Air tank or High Mount Outlet bracket.
  - 5a. Remove the M6 lower jack mounting bracket bolt as per Photo 3.
  - 5b. Completely remove the jack assembly by removing all jack housing mounting bolts, Refer to Photo 4 and high mount bracket instructions for reference.

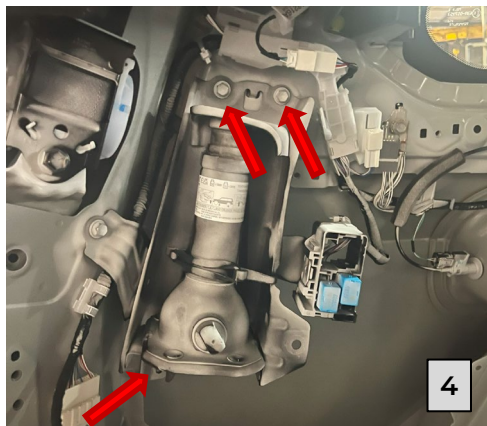
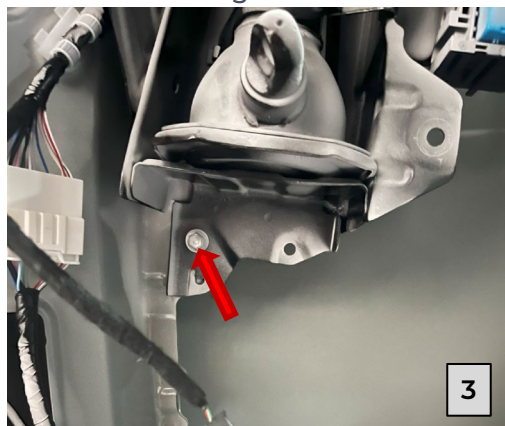

6. Mount the Air Compressor of choice to the mounting bracket. Install the Switch / Outlet mount and Upper bracket using the supplied M6x16 Bolts and Nyloc Nuts. See Photo 5.

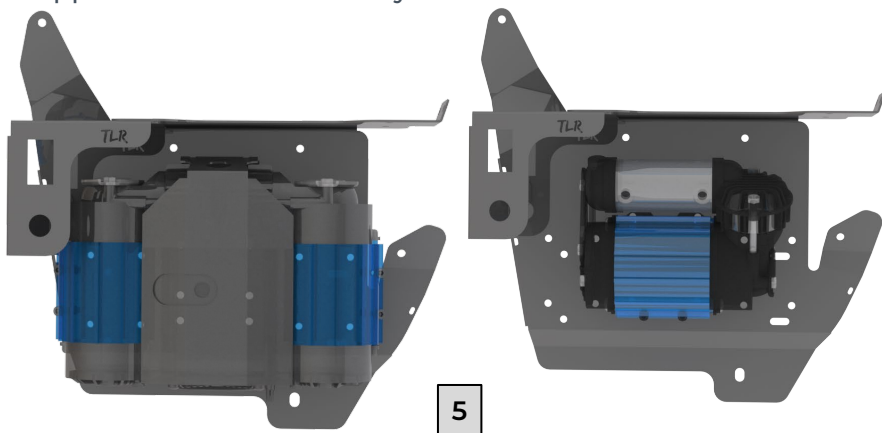

7. If installing an air manifold, there are mounting provisions for this located on the backside of the TLR Products compressor bracket.
8. Position the assembled compressor and mounting bracket into the inner guard cavity and align with the M6 captive nuts located in the body flange indicated by the red arrows. See Photo 6.
9. Install the factory M6 jack mounting bolt to the upper leg and the supplied M8x20 Bolt, Nyloc nut and Flat washers to the lower mounting point.
10. Install the TLR682106-4 brace using the M6x20 Bolts, Spring and Flat washers to the body flange, and M6x16 Bolts and Nyloc nuts to the upper bracket. Photo 7.

